

Plat of C. H. Miller's purchase of the south east, part of the
 Land Co's. Addition to the City of Snow Arden.

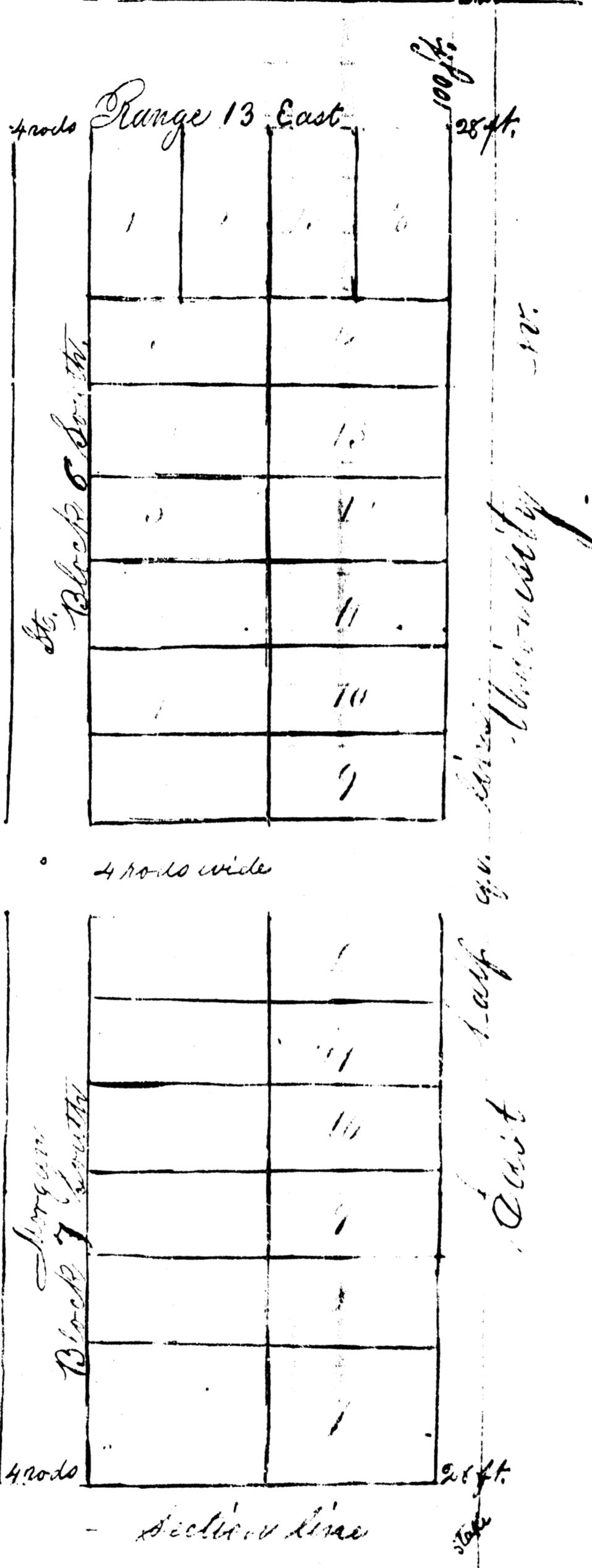

Five lots under rods to
 400 feet lots to 7 ft. in
 Block 7 south range
 13 east which have their
 widths marked on them.

Register of the Washburn County ss Received for record the 31st day of June 1865
 at 11 o'clock A.M. and entered in the 55th book on page 401 & July 1865
 State of Michigan Washburn County ss
 Snow Arden Michigan Oct. 30, 1865. On this 30th day of October 1865
 personally before me a Notary Public and in the county of Washburn Michigan
 of the land represented in the above plat and certifies that it is a true and
 correct copy of the original as shown to me by the said C. H. Miller
 State of Michigan ss On this 30th day of October 1865, I, the undersigned
 (Washburn County) ss and being in the presence of the said C. H. Miller
 and surveyor who certifies that the above is a true and correct copy of the
 original of the same as shown to me by the said C. H. Miller
 John G. ...
 Notary Public