

ADDENDUM No. II

ITB No. 4647

2020 Bridge Capital Preventative Maintenance Repairs

Bids Due: Wednesday, November 18, 2020 at 2:00 p.m. (Local Time)

The information contained herein shall take precedence over the original documents and all previous addenda (if any) and is appended thereto. **This Addendum includes 15 pages.**

Bidder is to acknowledge receipt of this Addendum No. II, including all attachments (if any) in its Bid by so indicating on page ITB-1 of the Invitation to Bid Form. Bids submitted without acknowledgment of receipt of this addendum may be considered nonconforming.

The following forms provided within the ITB document should be included in submitted bids:

- City of Ann Arbor Prevailing Wage Declaration of Compliance
- City of Ann Arbor Living Wage Ordinance Declaration of Compliance
- Vendor Conflict of Interest Disclosure Form
- City of Ann Arbor Non-Discrimination Ordinance Declaration of Compliance

Bids that fail to provide these forms listed above upon bid opening may be rejected as non-responsive and will not be considered for award.

I. CORRECTIONS/ADDITIONS/DELETIONS

Changes to the Bid document which are outlined below are referenced to a page or Section in which they appear conspicuously. The Bidder is to take note in its review of the documents and include these changes as they may affect work or details in other areas not specifically referenced here.

Section/Page(s)

Change

BF-2

Attached, please find the revised Page BF-2 REV 1 with the revised quantity shown for Item No. 7127011, Epoxy Ovly. The quantity has been revised to **1,144 yd²** as discussed in Addendum No. I.

The bid form is being revised to assist the bidders for this project and is page ADD-2-3 of this addendum.

Comment: The intent with this change is to correct an error that was found on the original bid form page.

Appendix I

Provide the approved EGLE Permit No. WRP025736 that details the requirements for the installation of the rip-rap and storm sewer outlet for the Island Drive portion of this project. The Contractor shall note that they are required to comply with all the terms and conditions of this permit

This permit can be found on pages ADD-2-4 through ADD-2-15 of this addendum.

Comment: Provide the approved EGLE Permit to be followed for installation of the proposed rip-rap and storm sewer outlet for the Island Drive portion of this project.

II. QUESTIONS AND ANSWERS

The following Questions have been received by the City. Responses are being provided in accordance with the terms of the ITB. Bidders are directed to take note in their review of the documents of the following questions and City responses as they affect work or details in other areas not specifically referenced here.

No new questions were asked since the issuance of Addendum No. 1 for this project.

Bidders are responsible for any conclusions that they may draw from the information contained in the Addendum.

BID FORM
Section 1 - Schedule of Prices

Company: _____

Project: 2020 Bridge Capital Preventative Maintenance Repairs

XXXXXXX Denotes an Item of Work to be performed in accordance with the 2012 MDOT Standard Specifications for Construction
 XXX7XXX Denotes an Item of Work to be performed in accordance with the project Detailed Specifications

ITB No. 4674

City File No. 2020-025

<u>Item No.</u>	<u>Item Description</u>	<u>Unit</u>	<u>Quantity</u>	<u>Unit Price</u>	<u>Total</u>
7120007	Hand Chipping, Other Than Deck	Cft	258	\$ _____	\$ _____
7120017	Patch, Forming	Sft	574	\$ _____	\$ _____
7127011	Epoxy Ovly	Syd	1144	\$ _____	\$ _____
7120041	Bolt, Adhesive Anchored, 5/8 inch	Ea	24	\$ _____	\$ _____
7127051	Structures, Rehabilitation, Rem Portions (Str 11081)	LSUM	1	\$ _____	\$ _____
7120112	Patching Conc, C-L	Cyd	101	\$ _____	\$ _____
7127010	Hand Chipping, Special	Sft	100	\$ _____	\$ _____
7127011	Healer/Sealer	Syd	3081	\$ _____	\$ _____
7127020	Beam End Repair, Latex Modified Conc	Cft	10	\$ _____	\$ _____
7127050	Conc Column Cap, Remove and Reset	Ea	2	\$ _____	\$ _____
7127050	Mechanical Anchor, Adjust, Complete	Ea	400	\$ _____	\$ _____
7137050	Bridge Railing, End Post, Galvanized	Ea	6	\$ _____	\$ _____
7137051	Lighting Conduit, Attach (Str 11081)	LSUM	1	\$ _____	\$ _____
8027001	Curb and Gutter, Conc, Det F4, Special	Ft	275	\$ _____	\$ _____
8037010	Detectable Warning Tiles	Sft	10	\$ _____	\$ _____
8037010	Sidewalk, Concrete, 6 inch, Special	Sft	1583	\$ _____	\$ _____
8070012	Guardrail, Curved, Type MGS-8	Ft	32	\$ _____	\$ _____
8070130	Guardrail Anch, Bridge, Det M1	Ea	1	\$ _____	\$ _____
8077050	Guardrail Anch, Bridge, Det M1, Modified	Ea	1	\$ _____	\$ _____
8077050	Guardrail Post, Hand Dug	Ea	7	\$ _____	\$ _____
8087001	Fence, Chain Link, 72 inch, Vinyl-Coated	Ft	50	\$ _____	\$ _____
8110094	Pavt Mrkg, Polyurea, 6 inch, White	Ft	1540	\$ _____	\$ _____
8110095	Pavt Mrkg, Polyurea, 4 inch, Yellow	Ft	970	\$ _____	\$ _____
8120012	Barricade, Type III, High Intensity, Double Sided, Lighted, Furn	Ea	35	\$ _____	\$ _____
8120013	Barricade, Type III, High Intensity, Double Sided, Oper	Ea	41	\$ _____	\$ _____
TOTAL THIS PAGE				\$ _____	



NOTICE OF AUTHORIZATION

Permit Number: WRP025736 v. 1

Site Name: 81 - Island Drive Bridge over Traver Creek

Date Issued: November 4, 2020

Expiration Date: November 4, 2025

The Michigan Department of Environment, Great Lakes, and Energy (EGLE), Water Resources Division, P.O. Box 30458, Lansing, Michigan 48909-7958, under provisions of the Natural Resources and Environmental Protection Act, 1994 PA 451, as amended, specifically:

- Part 31, Floodplain Regulatory Authority of the Water Resources Protection.
- Part 301, Inland Lakes and Streams.
- Part 303, Wetlands Protection.
- Part 315, Dam Safety.
- Part 323, Shorelands Protection and Management.
- Part 325, Great Lakes Submerged Lands.
- Part 353, Sand Dunes Protection and Management.

Authorized Activities: Install 22 cubic yards of riprap erosion protection at the Island Drive crossing of Traver Creek and construct a 1.0 foot diameter stormwater outfall pipe within the Huron River. All activities shall be completed in accordance with approved plans and conditions of this permit.

To be conducted at property located in: Washtenaw County, Waterbody: Traver Creek; Huron River Section 21, Town 02S, Range 06E, City of Ann Arbor

Permittee:

City of Ann Arbor - Project Management Services Unit
301 E Huron Street
Ann Arbor, Michigan 48104

John Skubinna
Transportation Review Unit
Water Resources Division
517-256-1469

*This notice must be displayed at the site of work.
Laminating this notice or utilizing sheet protectors is recommended.*
Please refer to the above permit number with any questions or concerns.
ADD-2-4

EGLE-WRD
WRP025736 v1.0
Approved
Issued On:11/04/2020
Expires On:11/04/2025



**MICHIGAN DEPARTMENT OF ENVIRONMENT, GREAT LAKES, AND ENERGY
WATER RESOURCES DIVISION PERMIT**

Issued To:

**City of Ann Arbor - Project Management Services Unit
301 E Huron Street
Ann Arbor, Michigan 48104**

Permit No: WRP025736 v.1
Submission No.: HP3-AQNA-J1K18
Site Name: 81 - Island Drive Bridge over Traver Creek
Issued: November 4, 2020
Revised:
Expires: November 4, 2025

This permit is being issued by the Michigan Department of Environment, Great Lakes, and Energy (EGLE), Water Resources Division, under the provisions of the Natural Resources and Environmental Protection Act, 1994 PA 451, as amended (NREPA); specifically:

- | | |
|---|---|
| <input checked="" type="checkbox"/> Part 301, Inland Lakes and Streams | <input type="checkbox"/> Part 323, Shorelands Protection and Management |
| <input type="checkbox"/> Part 303, Wetlands Protection | <input type="checkbox"/> Part 325, Great Lakes Submerged Lands |
| <input type="checkbox"/> Part 315, Dam Safety | <input type="checkbox"/> Part 353, Sand Dunes Protection and Management |
| <input checked="" type="checkbox"/> Part 31, Water Resources Protection (Floodplain Regulatory Authority) | |

Permission is hereby granted, based on permittee assurance of adherence to State of Michigan requirements and permit conditions, to:

Authorized Activities: Install 22 cubic yards of riprap erosion protection at the Island Drive crossing of Traver Creek and construct a 1.0 foot diameter stormwater outfall pipe within the Huron River. All activities shall be completed in accordance with approved plans and conditions of this permit.

Waterbody Affected: Traver Creek; Huron River
Property Location: Washtenaw County, City of Ann Arbor, Town/Range/Section 02S06E21
Property Tax No.

Authority granted by this permit is subject to the following limitations:

- A. Initiation of any work on the permitted project confirms the permittee's acceptance and agreement to comply with all terms and conditions of this permit.
- B. The permittee, in exercising the authority granted by this permit, shall not cause unlawful pollution as defined by Part 31 of the NREPA.
- C. This permit shall be kept at the site of the work and available for inspection at all times during the duration of the project or until its date of expiration.
- D. All work shall be completed in accordance with the approved plans and specifications submitted with the application and/or plans and specifications attached to this permit.

- E. No attempt shall be made by the permittee to forbid the full and free use by the public of public waters at or adjacent to the structure or work approved.
- F. It is made a requirement of this permit that the permittee give notice to public utilities in accordance with 2013 PA 174 (Act 174) and comply with each of the requirements of Act 174.
- G. This permit does not convey property rights in either real estate or material, nor does it authorize any injury to private property or invasion of public or private rights, nor does it waive the necessity of seeking federal assent, all local permits, or complying with other state statutes.
- H. This permit does not prejudice or limit the right of a riparian owner or other person to institute proceedings in any circuit court of this state when necessary to protect his rights.
- I. Permittee shall notify EGLE within one week after the completion of the activity authorized by this permit by completing and forwarding the attached preaddressed postcard to the office addressed thereon.
- J. This permit shall not be assigned or transferred without the written approval of EGLE.
- K. Failure to comply with conditions of this permit may subject the permittee to revocation of permit and criminal and/or civil action as cited by the specific state act, federal act, and/or rule under which this permit is granted.
- L. All dredged or excavated materials shall be disposed of in an upland site (outside of floodplains, unless exempt under Part 31 of the NREPA, and wetlands).
- M. In issuing this permit, EGLE has relied on the information and data that the permittee has provided in connection with the submitted application for permit. If, subsequent to the issuance of a permit, such information and data prove to be false, incomplete, or inaccurate, EGLE may modify, revoke, or suspend the permit, in whole or in part, in accordance with the new information.
- N. The permittee shall indemnify and hold harmless the State of Michigan and its departments, agencies, officials, employees, agents, and representatives for any and all claims or causes of action arising from acts or omissions of the permittee, or employees, agents, or representative of the permittee, undertaken in connection with this permit. The permittee's obligation to indemnify the State of Michigan applies only if the state: (1) provides the permittee or its designated representative written notice of the claim or cause of action within 30 days after it is received by the state, and (2) consents to the permittee's participation in the proceeding on the claim or cause of action. It does not apply to contested case proceedings under the Administrative Procedures Act, 1969 PA 306, as amended, challenging the permit. This permit shall not be construed as an indemnity by the State of Michigan for the benefit of the permittee or any other person.
- O. Noncompliance with these terms and conditions and/or the initiation of other regulated activities not specifically authorized shall be cause for the modification, suspension, or revocation of this permit, in whole or in part. Further, EGLE may initiate criminal and/or civil proceedings as may be deemed necessary to correct project deficiencies, protect natural resource values, and secure compliance with statutes.
- P. If any change or deviation from the permitted activity becomes necessary, the permittee shall request, in writing, a revision of the permitted activity from EGLE. Such revision request shall include complete documentation supporting the modification and revised plans detailing the proposed modification. Proposed modifications must be approved, in writing, by EGLE prior to being implemented.
- Q. This permit may be transferred to another person upon written approval of EGLE. The permittee must submit a written request to EGLE to transfer the permit to the new owner. The new owner must also submit a written request to EGLE to accept transfer. The new owner must agree, in writing, to accept all conditions of the permit. A single letter signed by both parties that includes all the above information may be provided to EGLE. EGLE will review the request and, if approved, will provide written notification to the new owner.
- R. Prior to initiating permitted construction, the permittee is required to provide a copy of the permit to the contractor(s) for review. The property owner, contractor(s), and any agent involved in exercising the permit are held responsible to ensure that the project is constructed in accordance with all drawings and specifications. The contractor is required to provide a copy of the permit to all subcontractors doing work authorized by the permit.
- S. Construction must be undertaken and completed during the dry period of the wetland. If the area does not dry out, construction shall be done on equipment mats to prevent compaction of the soil.

- T. Authority granted by this permit does not waive permit requirements under Part 91, Soil Erosion and Sedimentation Control, of the NREPA, or the need to acquire applicable permits from the County Enforcing Agent (CEA).
- U. Authority granted by this permit does not waive permit requirements under the authority of Part 305, Natural Rivers, of the NREPA. A Natural Rivers Zoning Permit may be required for construction, land alteration, streambank stabilization, or vegetation removal along or near a natural river.
- V. The permittee is cautioned that grade changes resulting in increased runoff onto adjacent property is subject to civil damage litigation.
- W. Unless specifically stated in this permit, construction pads, haul roads, temporary structures, or other structural appurtenances to be placed in a wetland or on bottomland of the water body are not authorized and shall not be constructed unless authorized by a separate permit or permit revision granted in accordance with the applicable law.
- X. For projects with potential impacts to fish spawning or migration, no work shall occur within fish spawning or migration timelines (i.e., windows) unless otherwise approved in writing by the Michigan Department of Natural Resources, Fisheries Division.
- Y. Work to be done under authority of this permit is further subject to the following special instructions and specifications:
 - Z.
 - 1. Authority granted by this permit does not waive permit or program requirements under Part 91 of the NREPA or the need to acquire applicable permits from the CEA. To locate the Soil Erosion Program Administrator for your county, visit www.mi.gov/eglestormwater and select "Soil Erosion and Sedimentation Control Program" under "Related Links."
 - 2. The authority to conduct the activity as authorized by this permit is granted solely under the provisions of the governing act as identified above. This permit does not convey, provide, or otherwise imply approval of any other governing act, ordinance, or regulation, nor does it waive the permittee's obligation to acquire any local, county, state, or federal approval or authorization necessary to conduct the activity.
 - 3. No fill, excess soil, or other material shall be placed in any wetland, floodplain, or surface water area not specifically authorized by this permit, its plans, and specifications.
 - 4. This permit does not authorize or sanction work that has been completed in violation of applicable federal, state, or local statutes.
 - 5. The permit placard shall be kept posted at the work site in a prominent location at all times for the duration of the project or until permit expiration.
 - 6. This permit is being issued for the maximum time allowed and no extensions of this permit will be granted. Initiation of the construction work authorized by this permit indicates the permittee's acceptance of this condition. The permit, when signed by EGLE, will be for a five-year period beginning on the date of issuance. If the project is not completed by the expiration date, a new permit must be sought.
 - 7. Unless specifically stated under the "Permitted Activity" of this permit, construction pads, haul roads, temporary structures, or other structural appurtenances to be placed in a wetland or on bottomland of the waterbody are not authorized and shall not be constructed unless authorized by a separate permit or permit revision granted in accordance with the applicable law.
 - 8. No filling, grading, excavating, dredging or use of wetland is authorized by this permit.
 - 9. This permit does not authorize or sanction work that has been completed in violation of applicable federal, state, or local statutes.
 - 10. The permittee is responsible for acquiring all necessary easements or rights-of-way before commencing any work authorized by this permit. All construction operations relating to or part of this project shall be confined to the existing right-of-way limits or other acquired easements.

11. Temporary soil erosion and sedimentation control measures shall be installed before or upon commencement of the earth change and shall be maintained daily. Temporary soil erosion and sedimentation control measures shall be maintained until permanent soil erosion and sedimentation control measures are in place and the area is stabilized. Permanent soil erosion and sedimentation control measures for all slopes, channels, ditches, or any disturbed area shall be installed within five (5) calendar days after final grading or the final earth change has been completed.
12. All raw areas in uplands resulting from the permitted construction activity shall be effectively stabilized with sod and/or seed and mulch (or other technology specified by this permit or project plans) in a sufficient quantity and manner to prevent erosion and any potential siltation to surface waters or wetlands. Temporary stabilization measures shall be installed before or upon commencement of the permitted activity and shall be maintained until permanent measures are in place. Permanent measures shall be in place within five (5) days of achieving final grade.
13. All raw earth within 100 feet of a lake, stream, or wetland that is not brought to final stabilization by the end of the active growing season shall be temporarily stabilized with mulch blankets in accordance with the following dates: September 20th for the Upper Peninsula, October 1st for the Lower Peninsula north of US-10, and October 10th for the Lower Peninsula south of US-10.
14. This permit placard shall be kept posted at the work site, in a prominent location at all times for the duration of the project, or until permit expiration.
15. This permit is being issued for the maximum time allowed and no extensions of this permit will be granted. Initiation of the construction work authorized by this permit indicates the permittee's acceptance of this condition. The permit, when signed by EGLE, will be for a five-year period beginning at the date of issuance. If the project is not completed by the expiration date, a new permit must be sought.
16. During removal or repair of the existing structure, every precaution shall be taken to prevent debris from entering any watercourse. Any debris reaching the watercourse during the removal and/or reconstruction of the structure shall be immediately retrieved from the water. All material shall be disposed of in an acceptable manner consistent with local, state, and federal regulations.
17. Road fill side slopes terminating in the stream and any raw streambanks resulting from the construction, shall be stabilized with temporary measures in accordance with appropriate Best Management Practices based on site conditions, and if necessary, may be riprapped extending above the ordinary high water mark, before or upon commencement of the permitted activity. Temporary stabilization measures shall be maintained until permanent measures are in place.
18. All other road fill slopes, ditches, and other raw areas draining directly to the stream may be protected with riprap, sod and/or seed and mulch as may be necessary to provide effective erosion protection. The placement of riprap shall be limited to the minimum necessary to ensure proper stabilization of the side slopes and fill in the immediate vicinity of the structure.
19. If the project, or any portion of the project, is stopped and lies incomplete for any length of time (other than that encountered in a normal work week) every precaution shall be taken to protect the incomplete work from erosion, including the placement of temporary gravel bag riprap, temporary seeding and mulching, or other acceptable temporary protection.
20. No work shall be done in the stream during periods of above-normal flows except as necessary to prevent erosion.
21. No work or dredging within the water authorized by this permit is allowed from March 1 to June 30 due to critical spawning, migration, and/or recreational use periods.

22. All riprap shall be properly sized and graded based on wave action and velocity and shall consist of clean natural field stone or rock (free of paint, soil or other fines, asphalt, soluble chemicals, or organic material). Broken concrete, free of protruding metal, contaminants, and other foreign material may be used.



Issued By: _____

John Skubinna
Transportation Review Unit
Water Resources Division
517-256-1469

cc: Washtenaw County Drain Commissioner
Washtenaw CEA
Mr. Matt Konieczki, EGLE
Ms. Melissa Letosky, EGLE

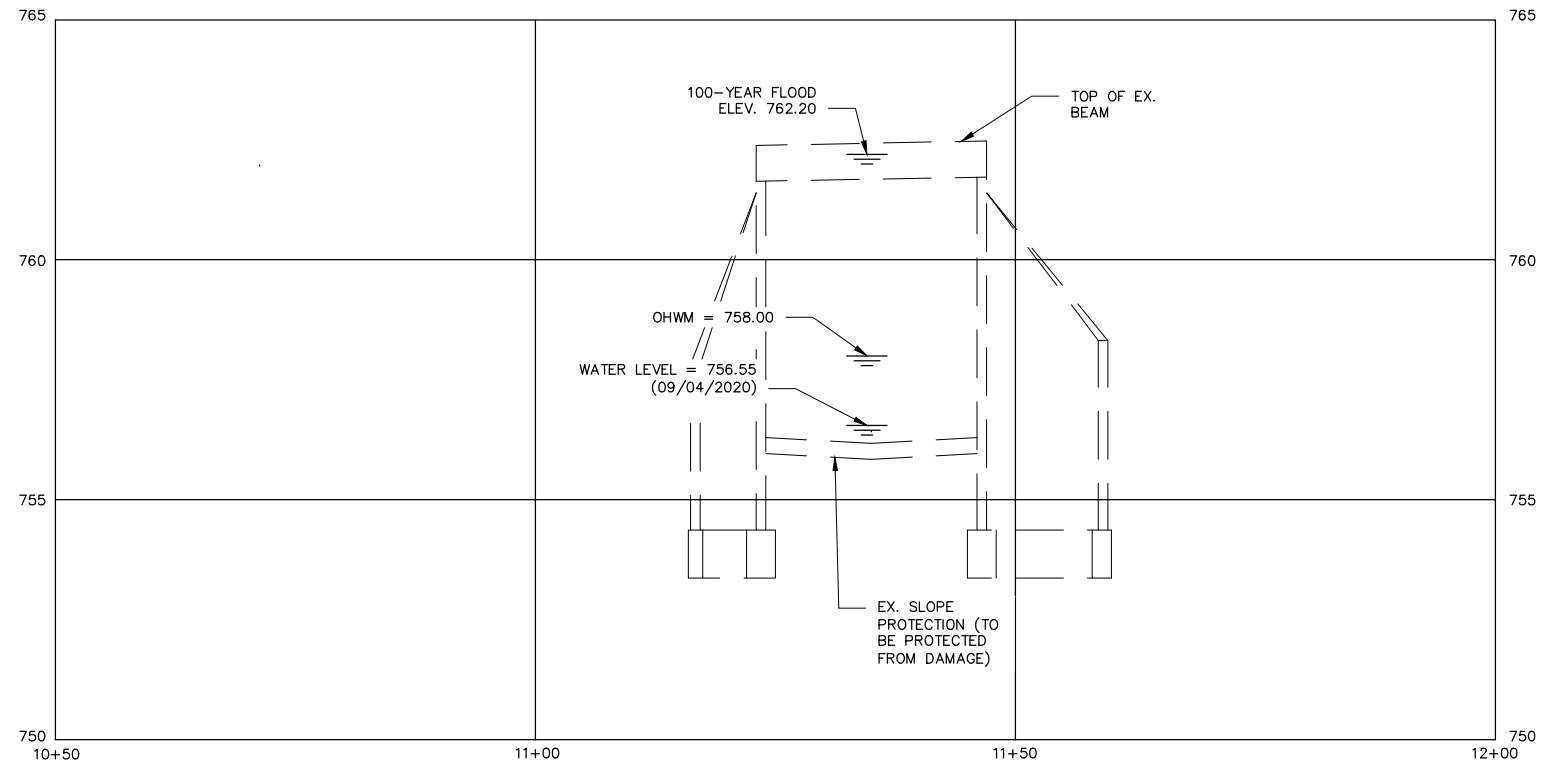

EXISTING CHANNEL SECTION

VERTICAL SCALE 1" = 4'

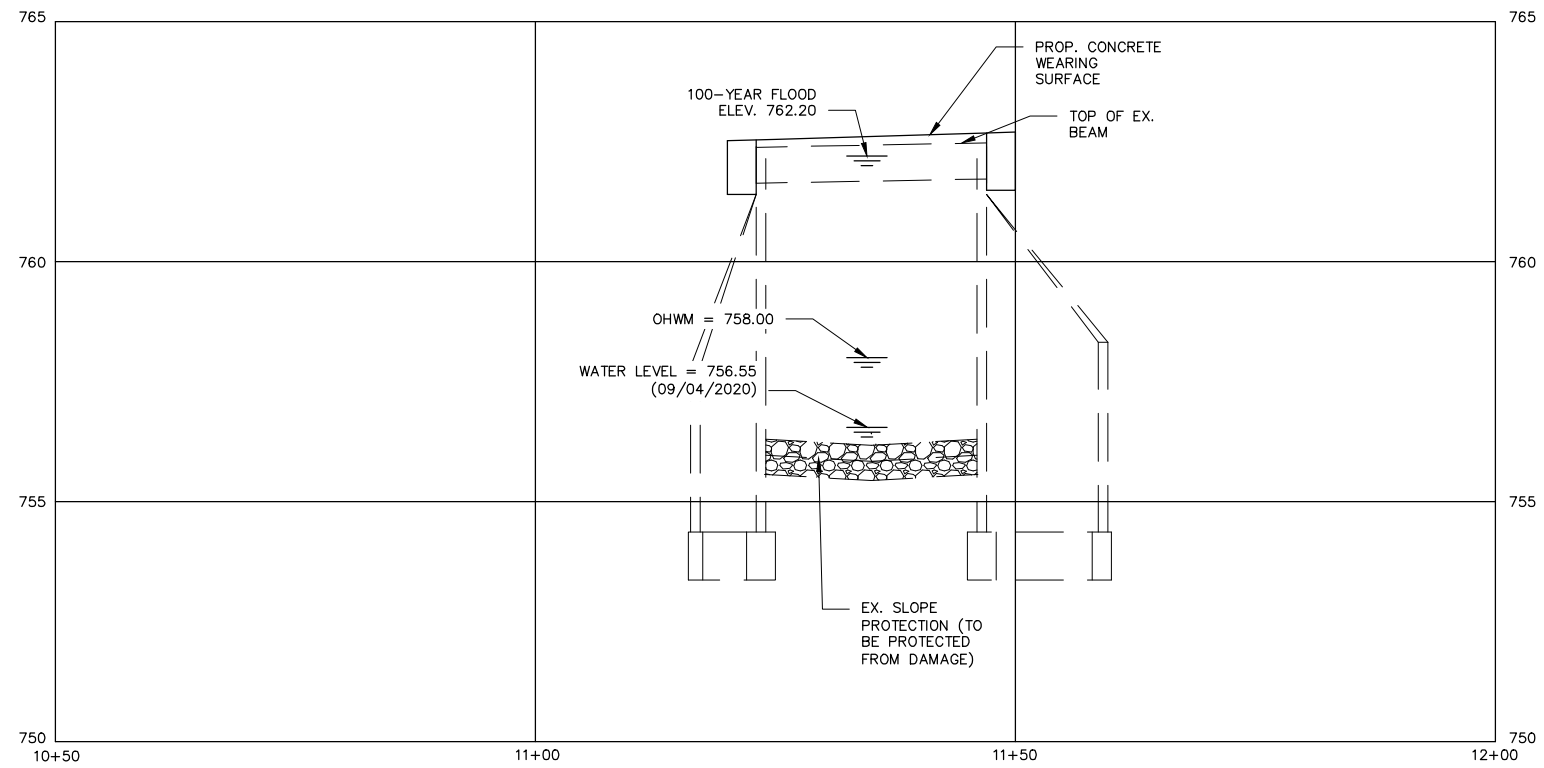

PROPOSED CHANNEL SECTION

VERTICAL SCALE 1" = 4'

ADD-2-10



REV.	DESCRIPTION	DATE	DRAWN	CHECKED

CITY OF ANN ARBOR
PUBLIC SERVICE
301 EAST HURON STREET
ANN ARBOR MI 48106-1667
www.a2gov.org



PROJECT MANAGEMENT - PUBLIC SERVICES - CITY OF ANN ARBOR
CITY OF ANN ARBOR 2020 BRIDGE
CAPITAL PREVENTIVE MAINTENANCE REPAIRS
CHANNEL CROSS SECTION

SCALE NONE
PROFILE: N/A
DRAWING No. 2020-025

FILED
WRP025736 v1.0
Approved

Issued On: 11/04/2020
Expires On: 11/04/2025



REV.	DESCRIPTION	DATE	DRAWN	CHECKED



PROJECT MANAGEMENT - PUBLIC SERVICES - CITY OF ANN ARBOR
 CITY OF ANN ARBOR 2020 BRIDGE
 CAPITAL PREVENTIVE MAINTENANCE REPAIRS
 REMOVAL SHEET

PROFILE: NA
 SCALE: NONE
 DRAWING NO.: 2020-025
 SHEET NO.: 1

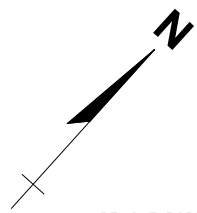

REMOVE PORTIONS OF EXISTING CHAIN LINK FENCE AS DIRECTED BY THE ENGINEER TO AN EXISTING CHAIN LINK POST (TYP. AT NORTHERN QUADRANTS). REMOVAL OF PORTIONS OF FENCE ATTACHED TO STRUCTURE INCLUDED IN "STRUCTURES, REHABILITATION, REM PORTIONS (11081)"

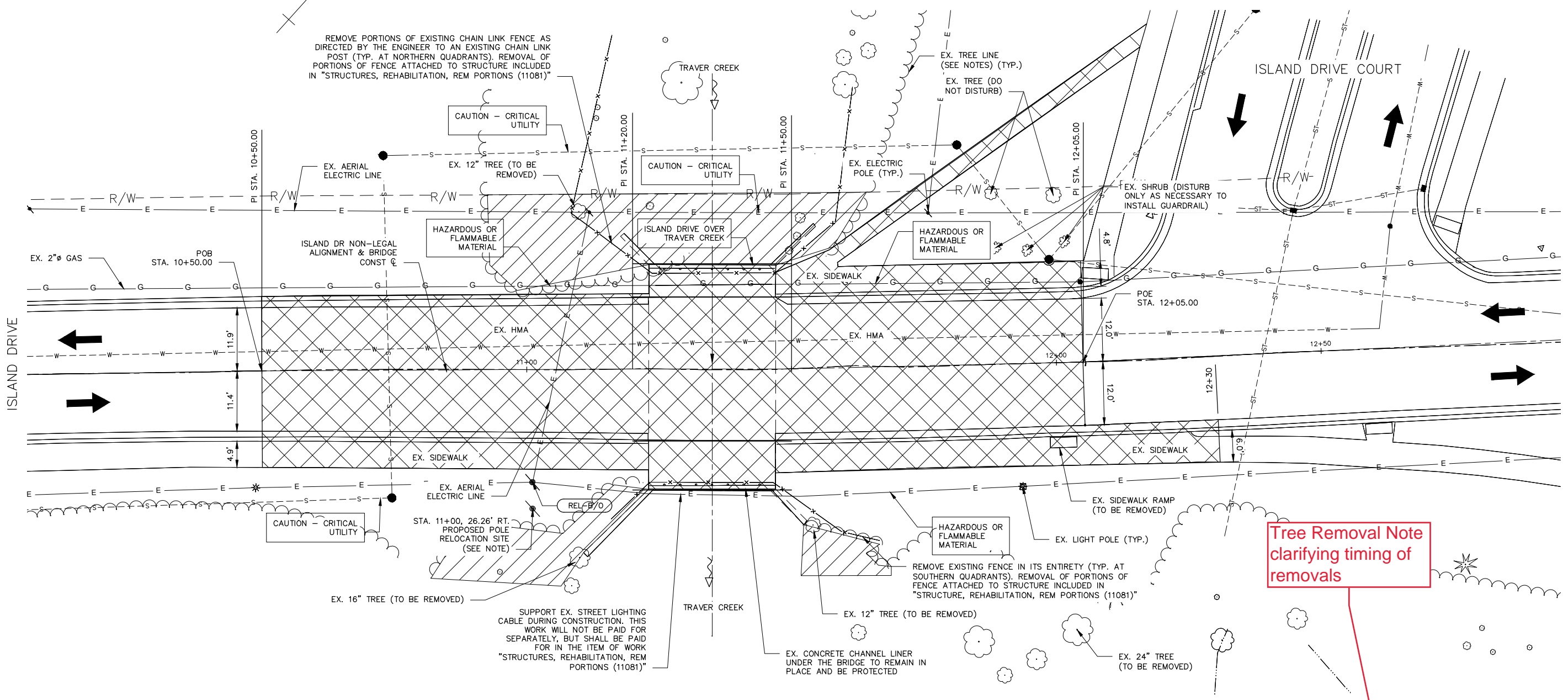

Tree Removal Note clarifying timing of removals

TREE REMOVAL SCHEDULE
 ALL TREES (8" AND LARGER) SHALL BE REMOVED PRIOR TO MARCH 30, 2021 IN ORDER TO COMPLY WITH FEDERAL REGULATIONS REGARDING ENDANGERED BAT ROOSTING AND NESTING AREAS. THE OTHER CLEARING ACTIVITIES MAY BE PERFORMED CONCURRENTLY AS LONG AS NO SOIL EROSION OR SEDIMENTATION ISSUES ARE CREATED BY THE REMOVAL OF THE REQUIRED TREES AND BRUSH.

STA	POINT	NORTHING	EASTING
8+95.00	BEGIN €	288016.43	13295021.55
10+50.00	PI	288134.53	13295121.93
11+20.00	PI	288187.39	13295167.82
11+50.00	PI	288209.94	13295187.60
12+05.00	PI	288252.15	13295222.87
13+15.00	END €	288338.09	13295291.52

CONTROL PT 1	DESCRIPTION : IRON PIN SET
COORDINATES : 288331.35, 13295263.72	ELEVATION : 762.44
CONTROL PT 2	DESCRIPTION : IRON PIN SET
COORDINATES : 288050.12, 13295079.38	ELEVATION : 761.39

BENCHMARK	ELEVATION	STATION	OFFSET	DESCRIPTION
BENCHMARK A	763.26	13+11.78	23.49' LT	RR SPIKE IN SOUTH SIDE OF UTILITY POLE, NE QUADRANT OF ISLAND DR AND ISLAND COURT DR.
BENCHMARK B	764.57	8+99.33	34.53' LT	SPIKE IN SE SIDE OF UTILITY POLE, ON NORTH SIDE OF ISLAND DR, IN FRONT OF BUILDING #1110

- LEGEND:**
- DENOTES REMOVED PORTIONS OF PAVEMENT, SIDEWALK, AND CURB AND GUTTER
 - DENOTES EXISTING FENCE (PORTIONS TO BE REMOVED)
 - DENOTES LIMITS OF CLEARING (SEE NOTES)

- NOTES:**
- POLE IS TO BE RELOCATED BY DTE PRIOR TO CONSTRUCTION. CONTRACTOR TO CONFIRM AND COORDINATE WITH DTE IF NECESSARY TO COMPLETE RELOCATION.
- REMOVE TREES AND BRUSH WITHIN 20 FEET OF THE STRUCTURE TO FACILITATE CONSTRUCTION. REMOVE TREES SPECIFICALLY MARKED FOR REMOVAL. REMOVE OTHER TREES, IF NECESSARY, AS DIRECTED BY THE ENGINEER.
- DO NOT REMOVE THE TREES LABELED AS "DO NOT DISTURB" IN THE NORTH QUADRANT, AND ONLY DISTURB THE SHRUBS AS NECESSARY TO INSTALL THE GUARDRAIL.
- REMOVE TREES AND BRUSH AS NECESSARY TO INSTALL THE PROPOSED STORM SEWER IN THE EAST QUADRANT TO FACILITATE CONSTRUCTION, AS DIRECTED BY THE ENGINEER. ONE 24 INCH TREE WHICH IS DIRECTLY IN CONFLICT WITH THE PROPOSED STORM SEWER HAS BEEN SPECIFICALLY MARKED FOR REMOVAL. REMOVE OTHER TREES, IF NECESSARY, AS DIRECTED BY THE ENGINEER.

ADD-2-11

ISLAND DRIVE OVER TRAVER CREEK

Issued On: 11/04/2020
 Expires On: 11/04/2025

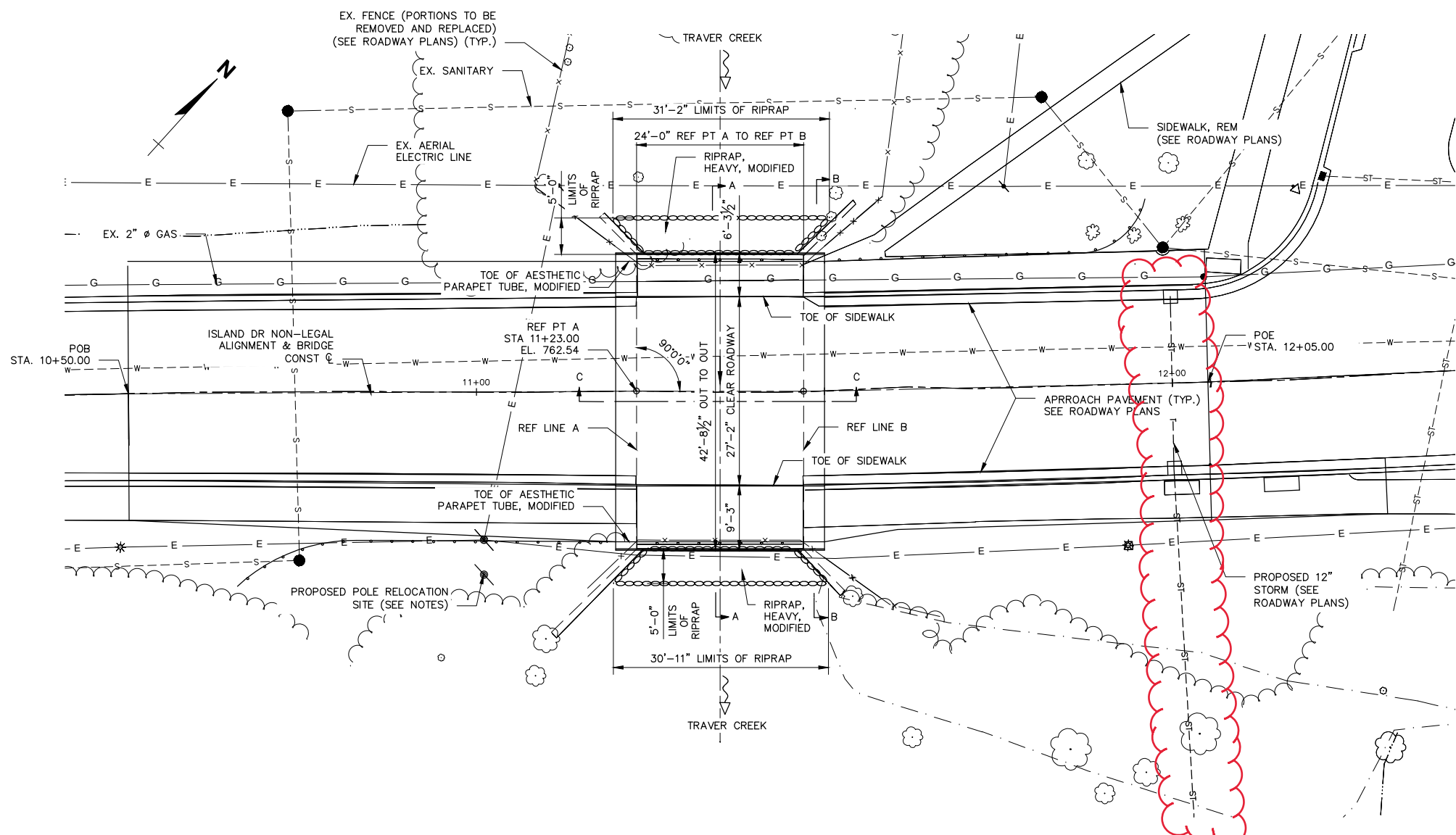

PLAN

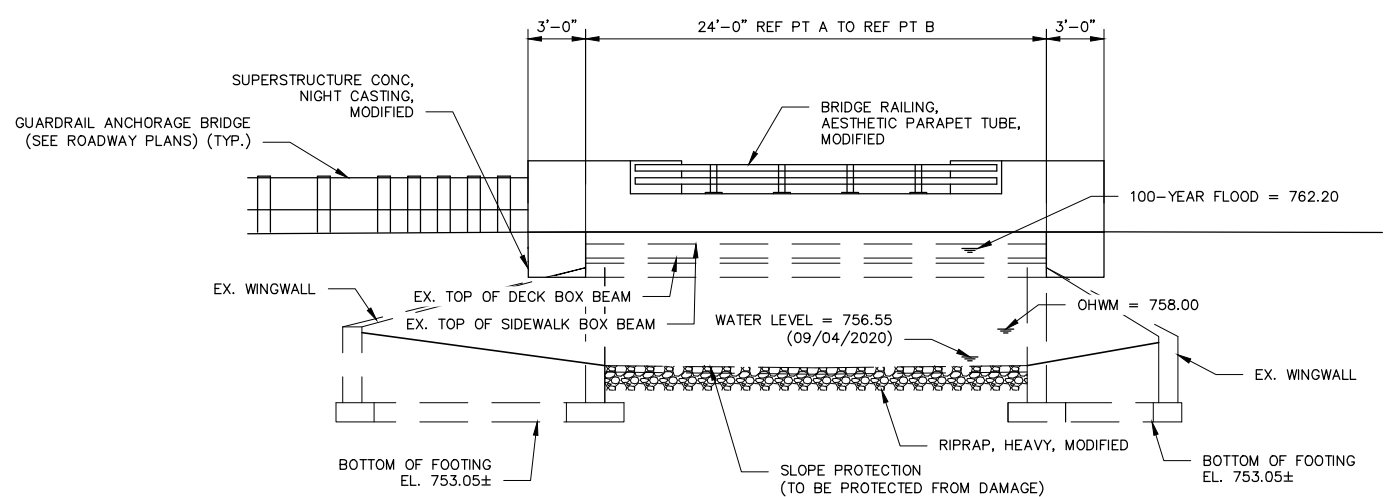

ELEVATION

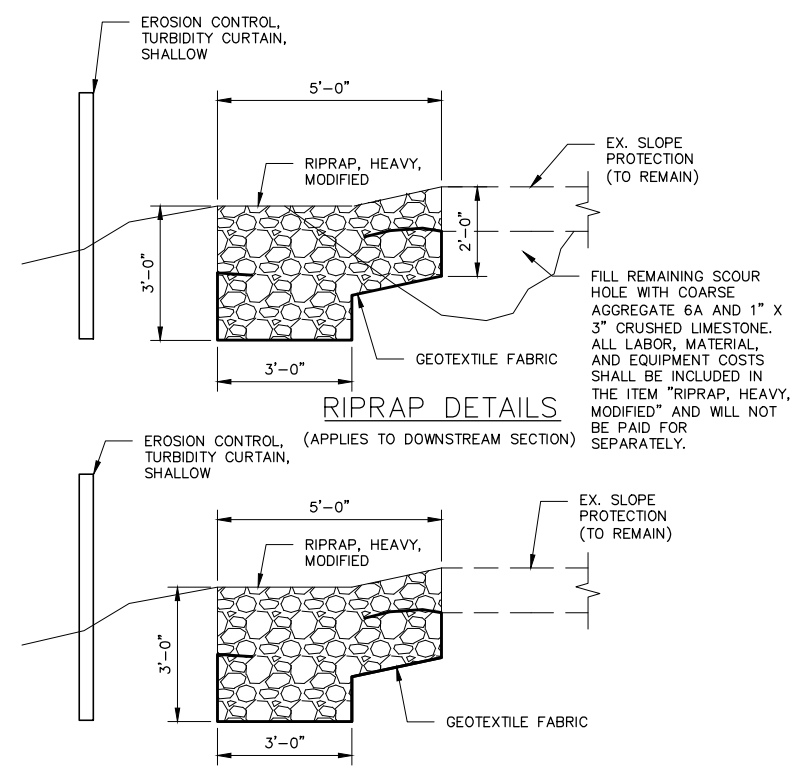

RIPRAP DETAILS

RIPRAP DETAILS

Area of proposed storm sewer construction

NOTES:

- THE WORK COVERED BY THESE PLANS INCLUDES REMOVAL OF THE EXISTING ASPHALT WEARING SURFACE, THE INSTALLATION OF A NEW CONCRETE WEARING SURFACE, BARRIER REPLACEMENT, SLOPE PROTECTION REPAIRS, AND MAINTAINING TRAFFIC.
- THE REHABILITATION DESIGN OF THIS STRUCTURE IS BASED ON THE CURRENT AASHTO STANDARD SPECIFICATIONS FOR HIGHWAY BRIDGES HS20-44. LIVE LOAD PLUS IMPACT DEFLECTION DOES NOT EXCEED 1/1000 OF SPAN LENGTH. THE ORIGINAL STRUCTURE WAS DESIGNED FOR H-20 LOADING.
- FOR DETAILS OF SLOPE PROTECTION, SEE STANDARD PLAN B-102-SERIES.
- THE RIPRAP QUANTITY IS BASED ON THE LATERAL DIMENSIONS OF THE AREA TO BE PROTECTED, REGARDLESS OF THE NUMBER OF LAYERS REQUIRED. THE ESTIMATED WEIGHT OF RIPRAP IS 48 TONS.
- POLE IS TO BE RELOCATED BY DTE PRIOR TO CONSTRUCTION. CONTRACTOR TO CONFIRM AND COORDINATE WITH DTE IF NECESSARY TO COMPLETE RELOCATION.

ISLAND DRIVE OVER TRAVER CREEK

ADD-2-12

PROJECT MANAGEMENT - PUBLIC SERVICES - CITY OF ANN ARBOR
 CITY OF ANN ARBOR 2020 BRIDGE
 CAPITAL PREVENTIVE MAINTENANCE REPAIRS
 GENERAL PLAN OF STRUCTURE

REV.	DESCRIPTION	DATE	DRAWN	CHECKED

SCALE NONE
 PROFILE: N/A
 SHEET No. 2020-025

811 Know what's below. Call before you dig.

CITY OF ANN ARBOR
 PUBLIC SERVICE
 301 EAST HURON STREET
 ANN ARBOR, MI 48106-0667
 ANN 734.764.4410
 www.a2gov.org

WRP025736 v1.0
 Approved

Issued On: 11/04/2020
Expires On: 11/04/2025



REV.	DESCRIPTION	DATE	DRAWN	CHECKED

CITY OF ANN ARBOR
PUBLIC SERVICES
301 EAST HURON STREET
ANN ARBOR MI 48106-1667
www.a2gov.org



PROJECT MANAGEMENT - PUBLIC SERVICES - CITY OF ANN ARBOR
CITY OF ANN ARBOR 2020 BRIDGE
CAPITAL PREVENTIVE MAINTENANCE REPAIRS
GENERAL PLAN OF STRUCTURE

PROFILE: N/A
SCALE: NONE
DRAWING No. 2020-025
SHEET No. 13

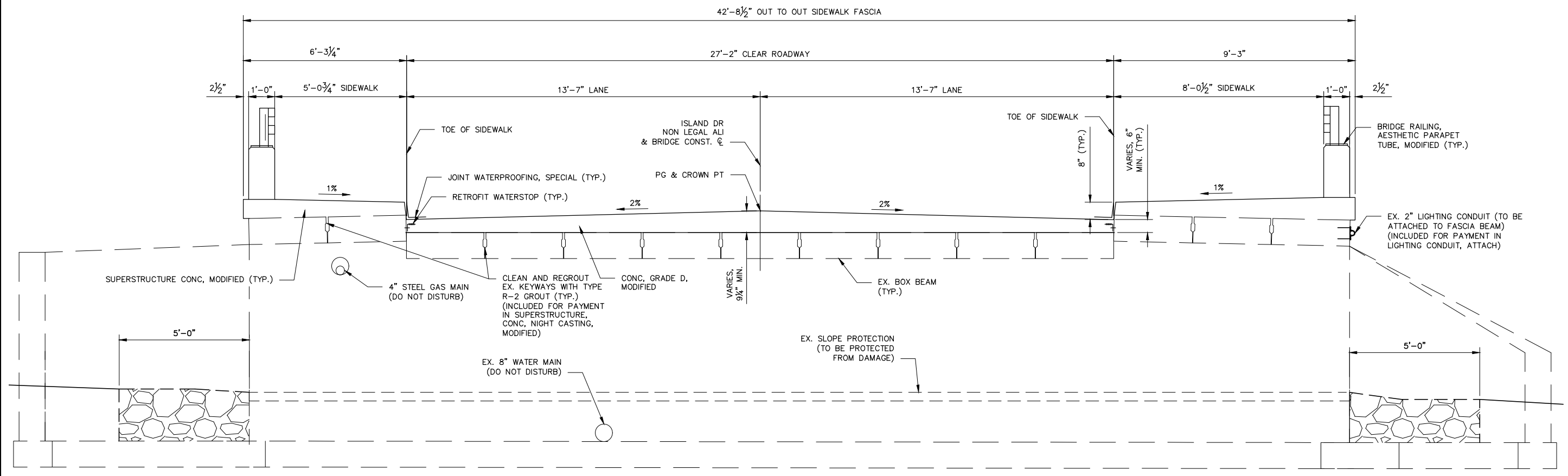

SECTION A-A

APPLIES STA. 11+23.00 TO STA. 11+47.00
(LOOKING EASTERLY)

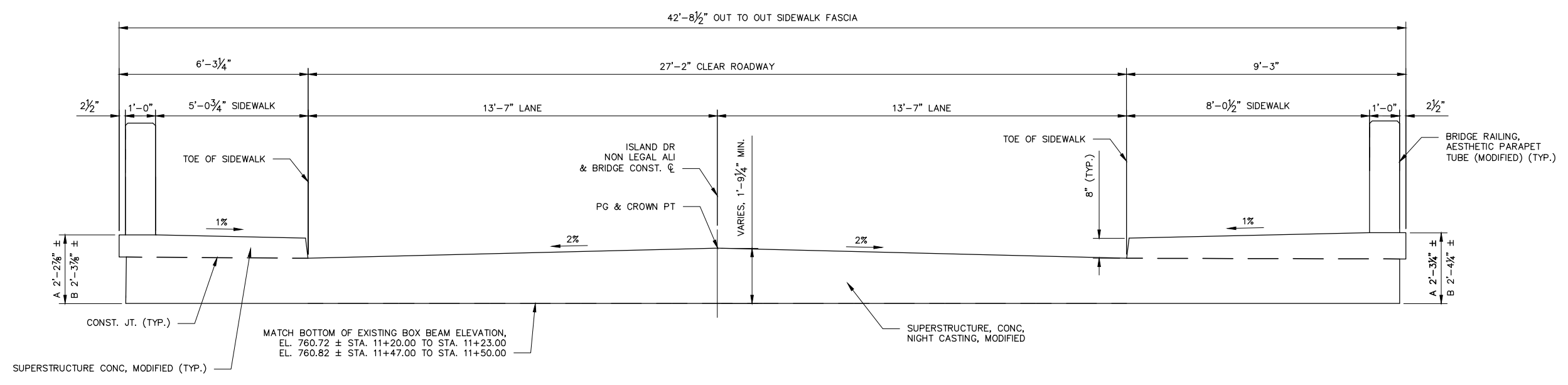

SECTION B-B

A STA. 11+20.00 TO STA. 11+23.00
B STA. 11+47.00 TO STA. 11+50.00
ADD 2-13 (LOOKING EASTERLY)

ISLAND DRIVE OVER TRAVER CREEK

ECLE WRD
WRP025736 v1.0
Approved

Issued On: 11/04/2020
Expires On: 11/04/2025

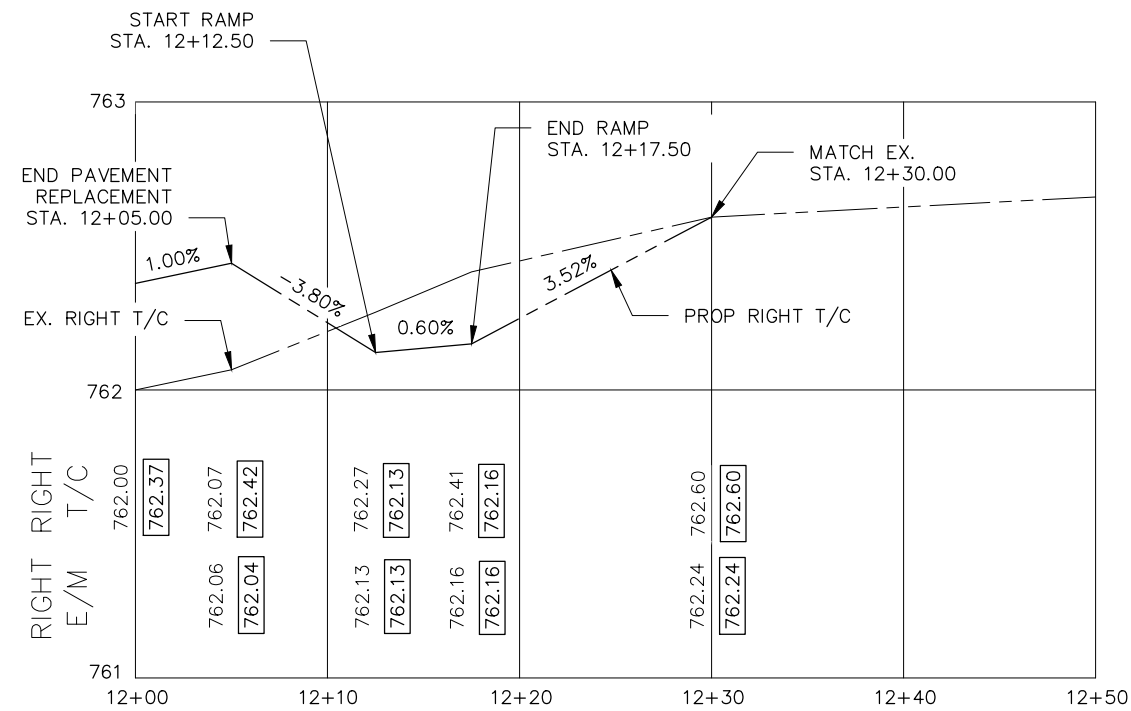
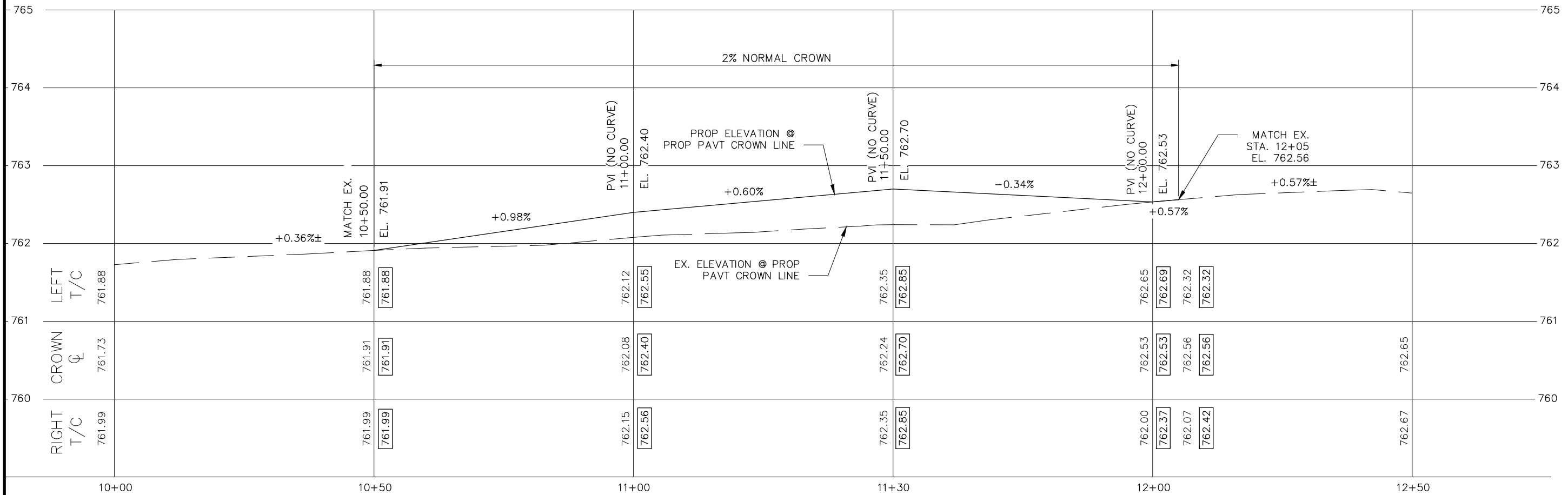

SIDEWALK RAMP DETAIL
(APPLIES RIGHT SIDE ONLY)

ADD-2-14

ISLAND DRIVE OVER TRAVER CREEK

REV.	DESCRIPTION	DATE	DRAWN	CHECKED

CITY OF ANN ARBOR
PUBLIC SERVICES
301 EAST HURON STREET
ANN ARBOR, MI 48106-1647
www.a2gov.org



PROJECT MANAGEMENT - PUBLIC SERVICES - CITY OF ANN ARBOR
CITY OF ANN ARBOR 2020 BRIDGE
CAPITAL PREVENTIVE MAINTENANCE REPAIRS
PROFILE SHEET

SCALE: NONE
PROFILE: NA
DRAWING No. 2020-025
SHEET No. 1

Approved
WRP025736 v1.0

Issued On: 11/04/2020
Expires On: 11/04/2025

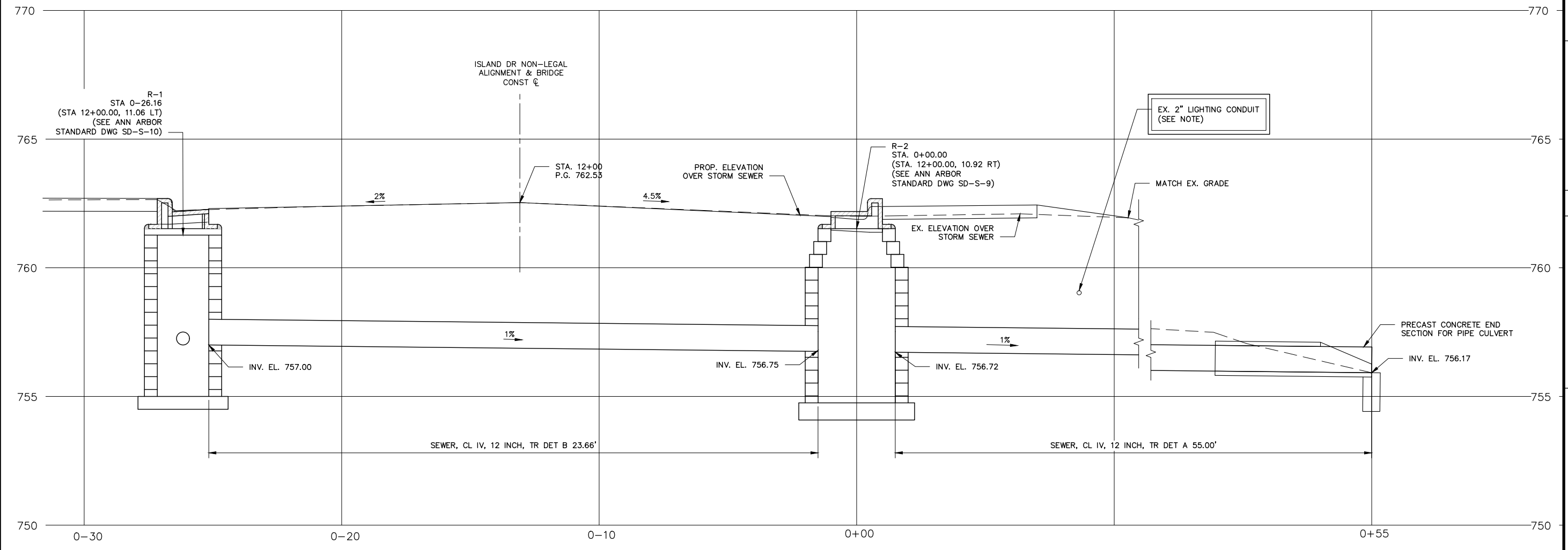

STRUCTURE/ STATION, OFFSET	TOP-OF-CASTING ELEVATION	E/M ELEVATION	INVERT ELEV. SIZE DIRECTION	DEPTH (FEET)	SIZE	APPLICATION/ CONSTRUCTION
R-1/ 12+00.00, 11.06' LT	762.69	762.28	757.50 6" UD 757.00 12" S	7.73'	SINGLE INLET	SINGLE INLET/NEW (COVER K)
R-2/ 12+00.00, 10.92' RT	762.37	761.96	757.25 6" UD 756.75 12" S	8.10'	3' DIA.	INLET JUNCTION - NEW (COVER K)

NOTES:

LOCATION OF EXISTING 2" LIGHTING CONDUIT IS APPROXIMATE. TAKE CARE WHEN EXCAVATING TO AVOID DAMAGING THIS CONDUIT, AND SUPPORT IT THROUGHOUT CONSTRUCTION TO AVOID DAMAGE. ANY DAMAGE TO THE EXISTING 2" LIGHTING CONDUIT WILL BE REPAIRED BY THE CONTRACTOR. SUPPORTING THE CONDUIT DURING CONSTRUCTION SHALL BE INCLUDED FOR PAYMENT IN "SEWER, CL IV, 12 INCH, TR DET A". NO ADDITIONAL PAYMENT WILL BE MADE TO REPAIR ANY DAMAGE TO THE EXISTING 2" LIGHTING CONDUIT.

REV.	DESCRIPTION	DATE	DRAWN	CHECKED

CITY OF ANN ARBOR
PUBLIC SERVICES
301 EAST HURON STREET
ANN ARBOR MI 48106-0647
www.a2gov.org



PROJECT MANAGEMENT - PUBLIC SERVICES - CITY OF ANN ARBOR
CITY OF ANN ARBOR 2020 BRIDGE
CAPITAL PREVENTIVE MAINTENANCE REPAIRS
STORM SEWER PROFILE

PROFILE: NA
SCALE: NONE
DRAWING No. 2020-025
SHEET No. 1

ISLAND DRIVE OVER TRAVER CREEK

ADD-2-15

Approved
WRP025736 v1.0

Issued On: 11/04/2020
Expires On: 11/04/2025