

City of Ann Arbor
Public Services Area • Project Management Unit
CONTROL STATION DATA SHEET

Approximate Location: Earhart Rd. and Pine Brae Dr.

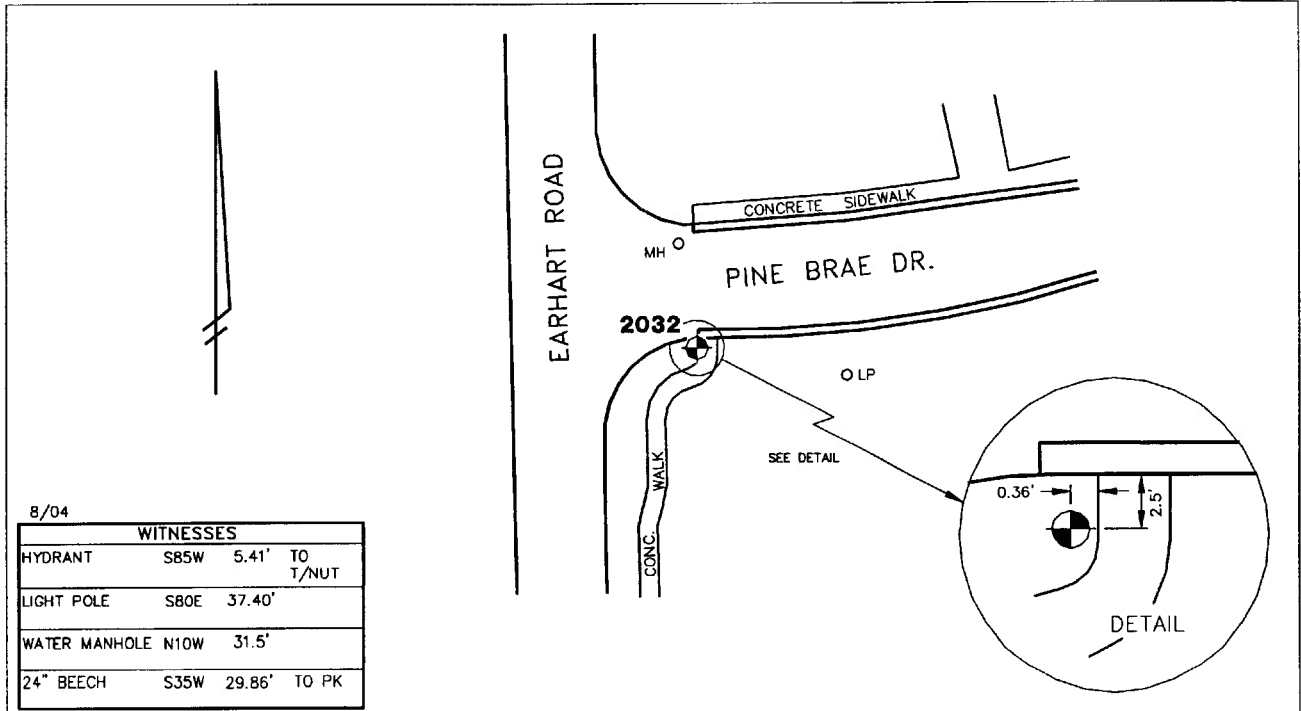

STATION 2032 IS LOCATED AT THE SOUTHEAST CORNER OF EARHART ROAD AND PINE BRAE DRIVE, SAID STATION BEING IN THE SOUTHWEST 1/4 OF SECTION 25, ANN ARBOR TOWNSHIP IN THE CITY OF ANN ARBOR, MICHIGAN. THE STATION IS LOCATED 2.5' SOUTHERLY OF THE SOUTHERLY BACK OF CURB ALONG THE SOUTHERLY SIDE OF PINE BRAE DRIVE AND 0.36' WESTERLY OF THE WESTERLY EDGE OF THE 5.0' CONCRETE WALK ALONG THE EASTERLY SIDE OF EARHART ROAD. SAID STATION IS A VERTICAL CONTROL STATION AND IS DESCRIBED AS THE 1972 EDITION OF THE CITY OF ANN ARBOR BRASS DISC, SET IN CONCRETE PER DETAIL III AND IS FLUSH WITH THE GROUND. THE STATION WAS SET BY THE CITY OF ANN ARBOR IN 1972.

Benchmark

Vertical

Accuracy	Local Control
Datum	NAVD 88
Elevation in meters	257.091
Elevation in International feet	843.47

No. 2032
Sector: EC