

**City of Ann Arbor
Public Services Area • Project Management Unit
CONTROL STATION DATA SHEET**

Approximate Location: Dexter Rd. at M-14

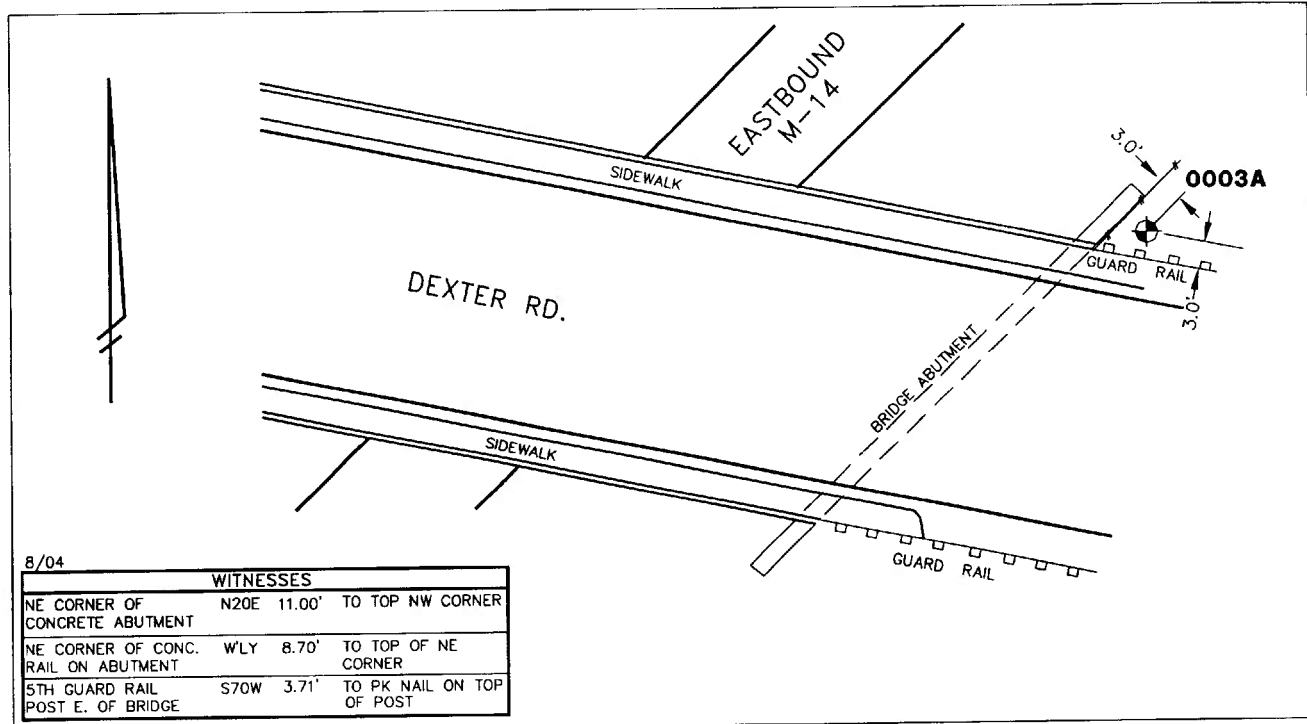

STATION 0003A IS LOCATED ON THE NORTHERLY SIDE OF DEXTER ROAD, EASTERLY OF M-14, SAID STATION BEING IN THE SOUTHWEST 1/4 OF SECTION 24, SCIO TOWNSHIP IN THE CITY OF ANN ARBOR, MICHIGAN. THE STATION IS LOCATED 3.0' NORTHERLY OF THE GUARDRAIL ALONG THE NORTHERLY SIDE OF DEXTER ROAD AND 3.0' EASTERLY OF THE EASTERLY EDGE OF THE EASTERLY CONCRETE BRIDGE ABUTMENT TO M-14. SAID STATION IS A PRIMARY CONTROL STATION AND IS DESCRIBED AS THE 1993 EDITION OF THE CITY OF ANN ARBOR BRASS DISC, SET IN CONCRETE PER DETAIL I AND IS FLUSH WITH THE GROUND. THIS STATION WAS SET BY THE CITY OF ANN ARBOR IN 1993 AND IS PAIRED WITH STATION 0003B.

Horizontal		Vertical	
Latitude (dms)	N 42 17 27.08086	Accuracy	2nd Order Class II
Longitude (dms)	W 83 47 48.63919	Datum	NAVD 88
State Plane Zone	2113 MI South	Elevation in meters	289.526
Scale	0.99996028	Elevation in International feet	949.89
Geoid Height in meters	-33.83		
Convergence (dms)	0 23 16.0		
Accuracy	1st Order		
Datum	NAD 83		
Easting (X) in meters	4046992.399		
Northing (Y) in meters	88005.859		
Easting (X) in International feet	13277534.117	Grid Azimuth to	
Northing (Y) in International feet	288733.133	Control Station 0003B	43°13'09"
			No. 0003A
			Sector: WC