

**City of Ann Arbor  
Public Services Area • Project Management Unit  
CONTROL STATION DATA SHEET**

**Approximate Location: Fuller Rd. at the Huron River**

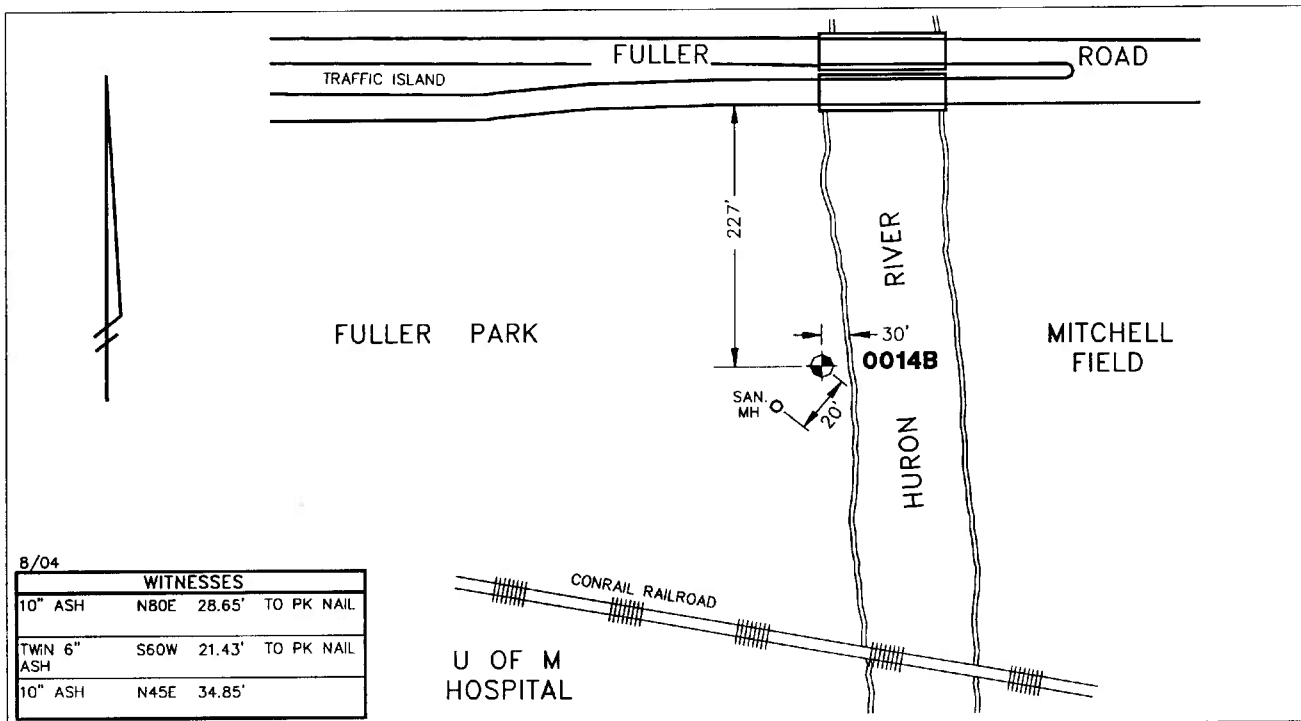

STATION 0014B IS LOCATED SOUTH OF FULLER ROAD ON THE WEST SIDE OF THE HURON RIVER, SAID STATION BEING IN THE NORTHEAST 1/4 OF SECTION 28, ANN ARBOR TOWNSHIP IN THE CITY OF ANN ARBOR, MICHIGAN. THE STATION IS LOCATED APPROXIMATELY 227' SOUTH OF THE SOUTH EDGE OF EASTBOUND FULLER ROAD, 30' WEST OF THE WEST BANK OF THE HURON RIVER AND 20' NORTHEAST OF A SANITARY MANHOLE. SAID STATION IS A PRIMARY CONTROL STATION AND IS DESCRIBED AS THE 1993 EDITION OF THE CITY OF ANN ARBOR BRASS DISC, SET IN CONCRETE PER DETAIL I AND IS FLUSH WITH THE GROUND. THIS STATION WAS SET BY THE CITY OF ANN ARBOR IN 1993 AND IS PAIRED WITH STATION 0014A.

Horizontal		Vertical	
Latitude (dms)	N 42 17 11.00210	Accuracy	2nd Order Class II
Longitude (dms)	W 83 43 32.81940	Datum	NAVD 88
State Plane Zone	2113 MI South	Elevation in meters	230.251
Scale	0.99996108	Elevation in International feet	755.42
Geoid Height in meters	-33.90		
Convergence (dms)	0 26 10.1		
Accuracy	1st Order		
Datum	NAD 83		
Eastings (X) in meters	4052856.367		
Northing (Y) in meters	87551.915		
Eastings (X) in International feet	13296772.858		
Northing (Y) in International feet	287243.816		
		<b>Grid Azimuth to Control Station 0014A</b>	<b>276°20'15"</b>
			<b>No. 0014B</b>
			<b>Sector: EC</b>