

City of Ann Arbor
Public Services Area • Project Management Unit
CONTROL STATION DATA SHEET

NGS PID

Approximate Location: Georgetown Blvd. and Bluett Rd.

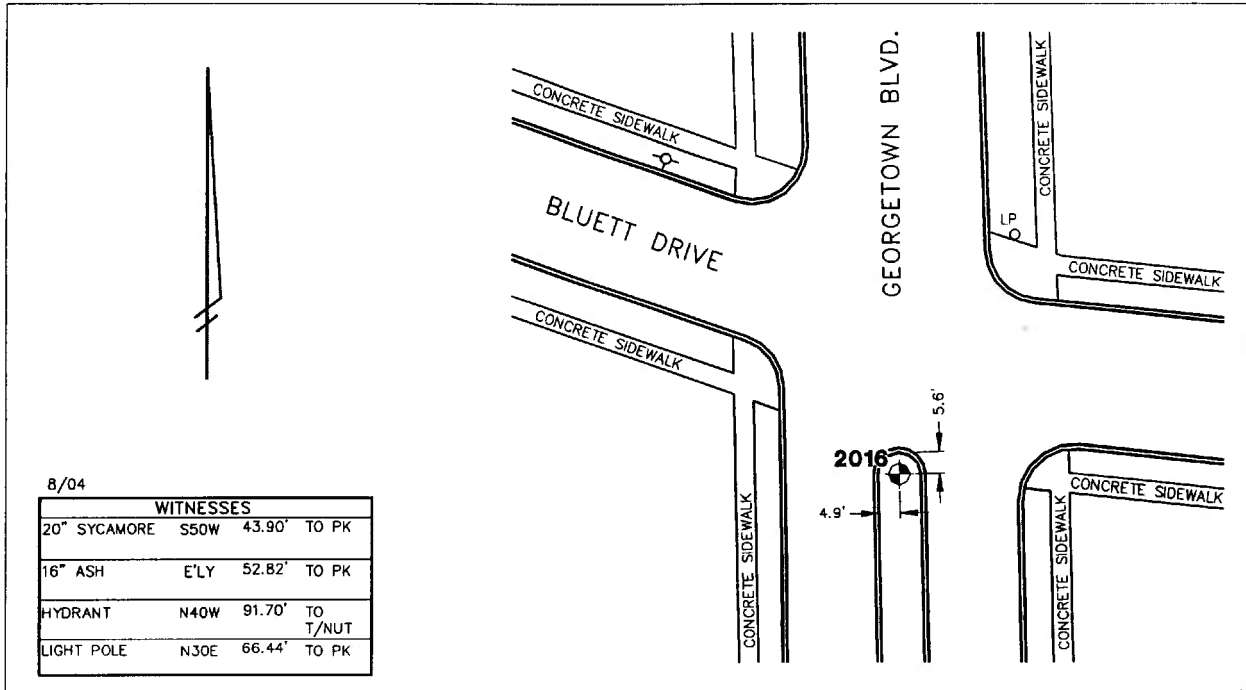

STATION 2016 IS LOCATED IN THE GRASS TRAFFIC ISLAND ON GEORGETOWN BOULEVARD AND SOUTHLERY OF BLUETT ROAD, SAID STATION BEING IN THE NORTHWEST 1/4 OF SECTION 14, ANN ARBOR TOWNSHIP IN THE CITY OF ANN ARBOR, MICHIGAN. THE STATION IS LOCATED 5.6' SOUTHERLY OF THE BACK OF CURB AT THE NORTHERLY END OF SAID TRAFFIC ISLAND AND 4.9' EASTERLY OF THE BACK OF CURB AT THE WESTERLY EDGE OF SAID TRAFFIC ISLAND. SAID STATION IS A VERTICAL CONTROL STATION AND IS DESCRIBED AS THE 1993 EDITION OF THE CITY OF ANN ARBOR BRASS DISC, SET IN CONCRETE PER DETAIL II AND IS FLUSH WITH THE GROUND. THE STATION WAS SET BY THE CITY OF ANN ARBOR IN 1998.

Benchmark

Vertical

Accuracy	Local Control
Datum	NAVD 88
Elevation in meters	278.580
Elevation in International feet	913.98

No. 2016
Sector: NE