

# WINDY CREST

A SUBDIVISION OF PART OF THE SW 1/4 OF SECTION 26, T25, R6E, ANN ARBOR TOWNSHIP, WASHTENAW COUNTY, MICHIGAN

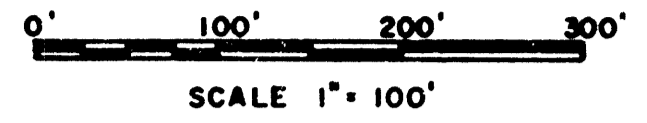

ALL DIMENSIONS ARE IN FEET  
 ALL BEARINGS ARE RELATED TO THE PLAT "HILL TOPS"  
 LIBER 9 - PAGE 52  
 CONCRETE MONUMENT SET AT POINTS MARKED "o"  
 3/4" X 1/8" IRON PIPE SET AT ALL LOT CORNERS

RESTRICTION CERTIFICATE:  
 THIS PLAT IS SUBJECT TO RESTRICTIONS AS REQUIRED BY ACT 208 OF 1967, AS AMENDED ON CERTAIN LOTS WITH RESPECT TO THE REQUIREMENTS OF THE MICHIGAN DEPARTMENT OF NATURAL RESOURCES AND/OR THE MICHIGAN DEPARTMENT OF PUBLIC HEALTH, WHICH ARE RECORDED IN LIBER 23 PAGES 520-4 AND 525 OF RECORDS OF THIS COUNTY

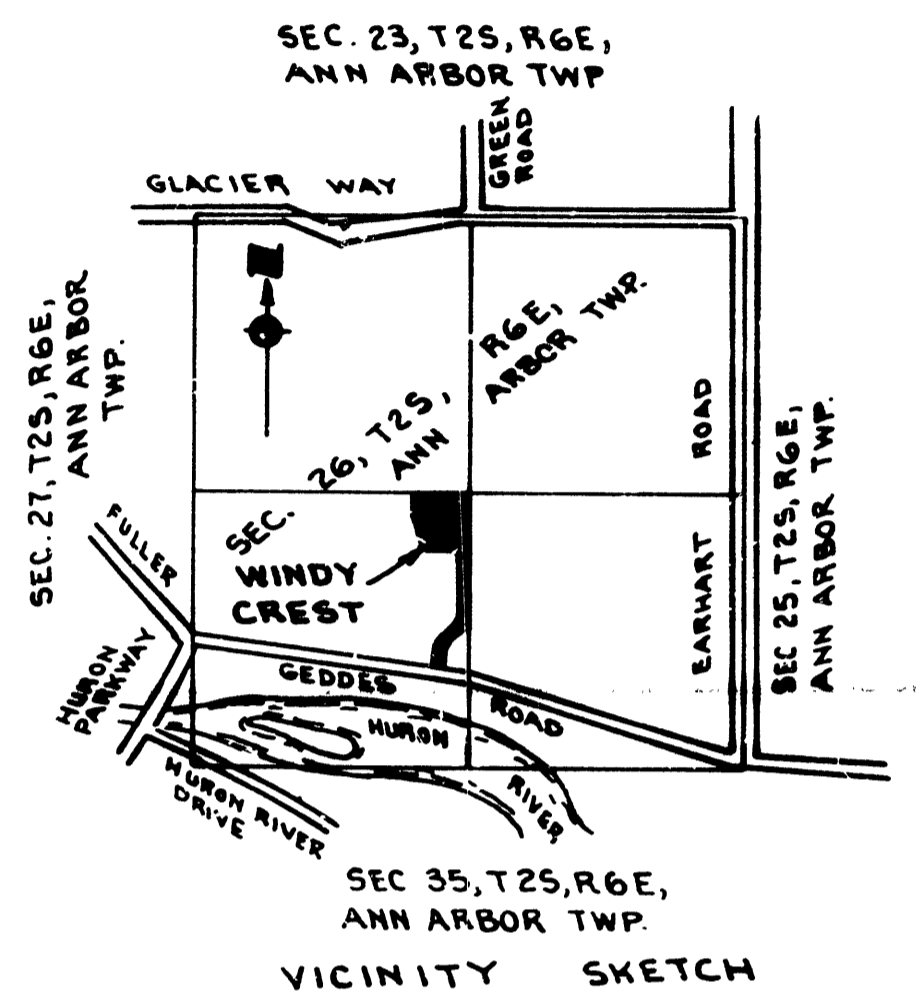

RECEIVED  
 FOR RECORDING  
 DEC 11 1 49 PM '80  
 MICHIGAN REGISTERED PROFESSIONAL SURVEYOR  
 WASHINGTON COUNTY, MICHIGAN

RECEIVED  
 FOR RECORDING  
 DEC 11 1 49 PM '80  
 MICHIGAN REGISTERED PROFESSIONAL SURVEYOR  
 WASHINGTON COUNTY, MICHIGAN  
 LIBER 23 OF PLATS  
 PAGES 17, 19, 20, 22

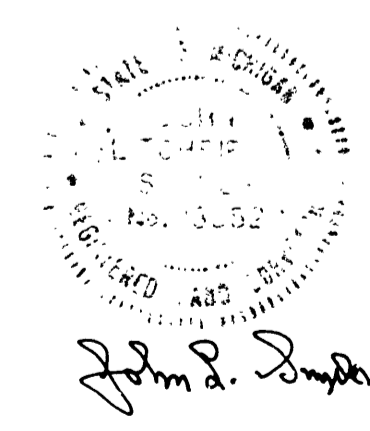

PREPARED AND DRAFTED BY ATWELL-HICKS, INC.  
 110 NORTH FIRST ST., ANN ARBOR, MICHIGAN 48104

RECEIVED  
FOR RECORD  
Dec 11 1 49 PM '80  
PATRICIA NEWKIRK HARDY  
REGISTER OF DEEDS  
WASHTENAW COUNTY, MICH.

WINDY CREST

A SUBDIVISION OF PART OF THE SW 1/4 OF SECTION 26, T2S, R6E,  
ANN ARBOR TOWNSHIP, WASHTENAW COUNTY, MICHIGAN

SURVEYOR'S CERTIFICATE

I, John L. Snyder, surveyor, certify:

That I have surveyed, divided and mapped the land shown on this plat, described as follows: WINDY CREST, a subdivision of part of the SW 1/4 of Section 26, T2S, R6E, Ann Arbor Township, Washtenaw County, Michigan.

Commencing at the North 1/4 corner of Section 26, T2S, R6E, Ann Arbor Township, Washtenaw County, Michigan; thence S 0°-20'-50" W 2650.02 feet along the North and South 1/4 line of said Section 26 to the PLACE OF BEGINNING; thence continuing along said North and South 1/4 line S 00°-00' E 1163.97 feet; thence S 57°-12'-30" W 160.37 feet; thence 95.76 feet along the arc of a circular curve to the left, radius 101.38 feet, chord S 30°-09' W 92.23 feet; thence S 03°-05'-30" W 123.20 feet; thence Westerly 40.09 feet along the arc of a nontangential circular curve to the right, radius 3988.91 feet, chord N 83°-08'-50" W 40.09 feet; thence N 03°-05'-30" E 120.57 feet; thence 133.54 feet along the arc of a circular curve to the right, radius 141.38 feet, chord N 30°-09' E 128.63 feet; thence N 57°-12'-30" E 86.77 feet; thence N 23°-56'-20" E 107.29 feet; thence N 00°-00' W 572.03 feet; thence S 89°-50'-50" W 404.0 feet; thence N 09°-55'-50" W 324.72 feet; thence N 00°-00' W 180.0 feet; thence N 89°-50'-50" E 500.0 feet along the East and West 1/4 line of said Section 26 to the Place of Beginning, containing 5 lots numbered 1 through 5 inclusive and containing 6.52 acres of land more or less.

That I have made such survey, land-division and plat by the direction of the owners of such land.

That such plat is a correct representation of all the exterior boundaries of the land surveyed and the subdivision of it.

That the required monuments and lot markers have been located in the ground or that surety has been deposited with the municipality, as required by Section 125 of the Act.

That the accuracy of survey is within the limits required by Section 126 of the Act.

That the bearings shown on the plat are expressed as required by Section 126 (3) of the Act and as explained in the legend.

August 14, 1980  
Date

ATWELL-HICKS, INC.  
110 North First Street  
Ann Arbor, Michigan 48104

*John E. Snyder*  
John E. Snyder, Vice-President  
Registered Land Surveyor #13352  
110 North First Street  
Ann Arbor, Michigan 48104



COUNTY PLAT BOARD CERTIFICATE

This plat has been reviewed and is approved by the Washtenaw County Plat Board on November 7, 1980 as being in compliance with all of the provisions of Act 288, P.A. 1967, and the Plat Board's applicable rules and regulations.

*Patricia Newkirk Hardy*  
Patricia Newkirk Hardy, Register of Deeds

*Robert M. Harrison*  
Robert M. Harrison, County Clerk

*Michael A. Stimpson*  
Michael A. Stimpson, County Treasurer

COUNTY TREASURER'S CERTIFICATE

The records in my office show no unpaid taxes or special assessments for the five years preceding September 5, 1980 involving the lands included in this plat.

*Michael A. Stimpson*  
Michael A. Stimpson  
Treasurer,  
Washtenaw County, Michigan

COUNTY DRAIN COMMISSIONER'S CERTIFICATE

Approved on September 9, 1980 as complying with Section 192 of Act 288, P.A. 1967, and the applicable rules and regulations published by my office in the County of Washtenaw.

*Thomas J. Blessing*  
Thomas J. Blessing  
Drain Commissioner

CERTIFICATE OF COUNTY ROAD COMMISSIONERS

Approved on September 23, 1980 as complying with Section 183 of Act 288, P.A. 1967 and the applicable rules and regulations of the Board of Road Commissioners of Washtenaw County.

*William R. Lynch*  
William R. Lynch, Chairman

*James K. Daniels*  
James K. Daniels, Vice-Chairman

*Bent F. Nielsen*  
Bent F. Nielsen, Member

CERTIFICATE OF MUNICIPAL APPROVAL

I certify that this plat was approved by the Township Board, of the Township of Ann Arbor, at a meeting held October 13, 1980 and was reviewed and found to be in compliance with Act 288, P.A. of 1967

Preliminary Plat approved  
by the Washtenaw County Health Department April 7, 1980

*Laurance Frederick*  
Laurance Frederick, Clerk

APPROVAL BY COUNTY PLANNING COMMISSION

This plat was approved by the Washtenaw County Metropolitan Planning Commission at a meeting held on the 8th day of October, 1980

*Thomas J. Fagan*  
Thomas J. Fagan, Director

*Kenneth Gates*  
Kenneth Gates, Chair

PROPRIETOR'S CERTIFICATE - CORPORATION

F/P Development Co., Inc., a corporation duly organized and existing under the laws of the State of Michigan, by David O. Peters, President and Richard E. Fry, Vice-President, as proprietor, has caused the land to be surveyed, divided, mapped and dedicated as represented on this plat and that Geddes Road is a public street and Windy Crest Drive is a private street only for the use of the lot owners and the owners of land west of and adjacent to Windy Crest Drive; that the public utility easements are private easements and that all other easements are for the uses shown on the plat.

Witnesses:

*Carol R. Peters*  
Carol R. Peters

*Cheryl L. Fryberger*  
Cheryl L. Fryberger

F/P Development Co., Inc.

*David O. Peters*  
David O. Peters, President  
1327 Jones Drive  
Ann Arbor, Michigan 48105

*Richard E. Fry*  
Richard E. Fry, Vice-President  
1327 Jones Drive  
Ann Arbor, Michigan 48105

ACKNOWLEDGEMENT

STATE OF MICHIGAN )  
) ss.  
County of Washtenaw )

Personally came before me this 11th day of August, 1980, David O. Peters, President and Richard E. Fry, Vice-President of the above named Corporation, to me known to be the persons who executed the foregoing instrument and to me known to be such President and Vice-President of said Corporation, and acknowledged that they executed the foregoing instrument as such officers as the free act and deed of said Corporation by its authority.

*Cheryl L. Fryberger*  
Cheryl L. Fryberger  
Notary Public, Washtenaw  
County, Michigan  
My Commission expires: 6/19/84

EXAMINED AND APPROVED  
Date Dec. 9, 1980

*James E. Monar*

LOWEN E. MICHAEL  
STATE TREASURER  
*Richard E. Lemaire*  
Richard E. Lemaire

RECORDING CERTIFICATE

STATE OF MICHIGAN )  
) ss.  
County of Washtenaw )

This plat was received for record on the 11th day of December, 1980, A.D. at 1:49 P. M., and recorded in Liber 23 of Plats, on page(s) 17, 18, 19 & 20.

*Patricia Newkirk Hardy*  
Patricia Newkirk Hardy  
Register of Deeds  
By: *Calhoun C. French*, Deputy

RECEIVED  
DEC 11 1 49 PM '80  
PATRICIA J. HARDY  
REGISTERED DEEDS  
WASHTENAW COUNTY, MICH

**WINDY CREST**  
A SUBDIVISION OF PART OF THE SW 1/4 OF SECTION 26, T2S, R6E.  
ANN ARBOR TOWNSHIP, WASHTENAW COUNTY, MICHIGAN

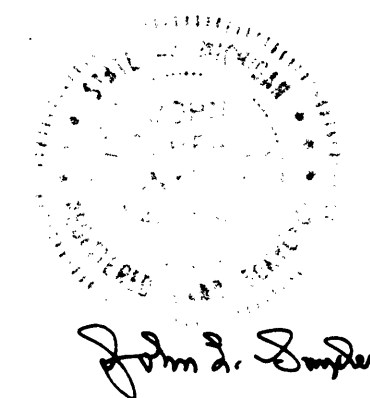

RECEIVED  
DEC 11 1 49 PM '80  
PATRICIA J. HARDY  
REGISTERED DEEDS  
WASHTENAW COUNTY, MICH

PROPRIETOR'S CERTIFICATE - CORPORATION

National Bank & Trust Company, a corporation duly organized and existing under the laws of the United States, by Byron J. Albrecht, Vice-President and James C. Handy III, Vice-President, as proprietor, has caused the land to be surveyed, divided, mapped and dedicated as represented on this plat and that Geddes Road is a public street and Windy Crest Drive is a private street only for the use of the lot owners and the owners of land west of and adjacent to Windy Crest Drive; that the public utility easements are private easements and that all other easements are for the uses shown on the plat.

Witnesses:  
Karen T. Otto  
Karen T. Otto  
Byron J. Albrecht  
Byron J. Albrecht  
Vice-President  
James C. Handy III  
James C. Handy III  
Vice-President  
National Bank & Trust Company  
125 South Main Street  
Ann Arbor, Michigan 48104

ACKNOWLEDGEMENT

STATE OF MICHIGAN )  
 ) ss.  
County of Washtenaw )

Personally came before me this 21<sup>st</sup> day of August, 1980, Byron J. Albrecht, Vice-President and James C. Handy III, Vice-President of the above named Corporation, to me known to be the persons who executed the foregoing instrument and to me known to be such Vice-President and Vice-President of said Corporation, and acknowledged that they executed the foregoing instrument as such officers as the free act and deed of said Corporation by its authority.

Robert E. Blackman  
Robert E. Blackman  
Notary Public, Washtenaw  
County, Michigan  
My Commission expires:  
March 17, 1983

PROPRIETOR'S CERTIFICATE

We as proprietor's certify that we have caused the land embraced in this plat to be surveyed, divided, mapped and dedicated as represented on this plat and that Geddes Road is a public street and Windy Crest Drive is a private street only for the use of the lot owners and the owners of land west of and adjacent to Windy Crest Drive; that the public utility easements are private easements and that all other easements are for the uses shown on the plat.

Witnesses:  
Carol R. Peters  
Carol R. Peters  
Raymond W. Waggoner  
Raymond W. Waggoner  
3333 Ceddes Road  
Ann Arbor, MI 48105  
David O. Peters  
David O. Peters  
Marian D. Waggoner  
Marian D. Waggoner  
3333 Ceddes Road  
Ann Arbor, MI 48105

ACKNOWLEDGEMENT

STATE OF MICHIGAN )  
 ) ss.  
County of Washtenaw )

Personally came before me this 20<sup>th</sup> day of August, 1980, the above named Raymond W. Waggoner and Marian D. Waggoner, husband and wife, to me known to be the persons who executed the foregoing instrument and acknowledged that they executed the same as their free act and deed.

Cheryl L. Fryberger  
Cheryl L. Fryberger  
Notary Public, Washtenaw County,  
Michigan  
My Commission expires: 6/19/84

PROPRIETOR'S CERTIFICATE

We as proprietor's certify that we have caused the land embraced in this plat to be surveyed, divided, mapped and dedicated as represented on this plat and that Geddes Road is a public street and Windy Crest Drive is a private street only for the use of the lot owners and the owners of land west of and adjacent to Windy Crest Drive; that the public utility easements are private easements and that all other easements are for the uses shown on the plat.

Witnesses:  
David O. Peters  
David O. Peters  
Carol R. Peters  
Carol R. Peters  
Terral M. deJonckheere  
Terral M. deJonckheere  
847 Greenhills Drive  
Ann Arbor, MI 48105  
Margaret F. deJonckheere  
Margaret F. deJonckheere  
847 Greenhills Drive  
Ann Arbor, MI 48105

ACKNOWLEDGEMENT

STATE OF MICHIGAN )  
 ) ss.  
County of Washtenaw )

Personally came before me this 21<sup>st</sup> day of August, 1980, the above named Terral M. deJonckheere and Margaret F. deJonckheere, husband and wife, to me known to be the persons who executed the foregoing instrument and acknowledged that they executed the same as their free act and deed.

Cheryl L. Fryberger  
Cheryl L. Fryberger  
Notary Public, Washtenaw  
County, Michigan  
My Commission expires: 6/19/84

PROPRIETOR'S CERTIFICATE

We as proprietor's certify that we have caused the land embraced in this plat to be surveyed, divided, mapped and dedicated as represented on this plat and that Geddes Road is a public street and Windy Crest Drive is a private street only for the use of the lot owners and the owners of land west of and adjacent to Windy Crest Drive; that the public utility easements are private easements and that all other easements are for the uses shown on the plat.

Witnesses:  
Cheryl L. Fryberger  
Cheryl L. Fryberger  
Paul J. Morel  
Paul J. Morel  
325 Windy Crest Drive  
Ann Arbor, MI 48105  
David O. Peters  
David O. Peters  
Jane T. Morel  
Jane T. Morel  
325 Windy Crest Drive  
Ann Arbor, MI 48105

ACKNOWLEDGEMENT

STATE OF MICHIGAN )  
 ) ss.  
County of Washtenaw )

Personally came before me this 2<sup>nd</sup> day of September, 1980, the above named Paul J. Morel and Jane T. Morel, husband and wife, to me known to be the persons who executed the foregoing instrument and acknowledged that they executed the same as their free act and deed.

Cheryl L. Fryberger  
Cheryl L. Fryberger  
Notary Public, Washtenaw  
County, Michigan  
My Commission expires: 6/19/84

RECEIVED  
FOR RECORD  
DEC 11 1 49 PM '80  
PATRICIA K. WILSON HARDY  
REGISTRAR OF DEEDS  
WASHTENAW COUNTY, MICH.

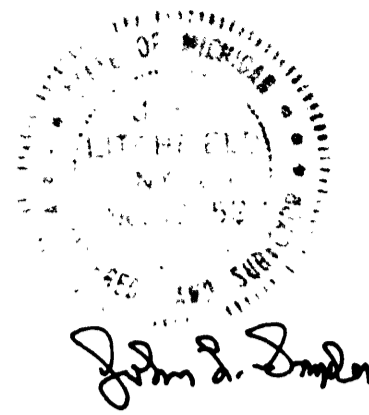

**WINDY CREST**  
A SUBDIVISION OF PART OF THE SW 1/4 OF SECTION 26, T2S, R6E,  
ANN ARBOR TOWNSHIP, WASHTENAW COUNTY, MICHIGAN

PROPRIETOR'S CERTIFICATE

We as proprietor's certify that we have caused the land embraced in this plat to be surveyed, divided, mapped, and dedicated as represented on this plat and that Geddes Road is a public street and Windy Crest Drive is a private street only for the use of the lot owners and the owners of land west of and adjacent to Windy Crest Drive; that the public utility easements are private easements and that all other easements are for the uses shown on the plat.

Witnesses:

R.E. Fry  
R.E. FRY

David O. Peters  
David O. Peters  
365 Windy Crest Drive  
Ann Arbor, MI 48105

Cheryl L. Fryberger  
CHERYL L. FRYBERGER

Carol R. Peters  
Carol R. Peters  
365 Windy Crest Drive  
Ann Arbor, MI 48105

ACKNOWLEDGEMENT

STATE OF MICHIGAN )  
County of Washtenaw ) ss.

Personally came before me this 4th day of September, 1980, the above named David O. Peters and Carol R. Peters, husband and wife, come known to be the persons who executed the foregoing instrument and acknowledged that they executed the same as their free act and deed.

Cheryl L. Fryberger  
CHERYL L. FRYBERGER  
Notary Public, Washtenaw  
County, Michigan  
My Commission expires: 6/19/84

PROPRIETOR'S CERTIFICATE - CORPORATION

Michigan National Bank - Ann Arbor, a corporation duly organized and existing under the laws of the United States, by Michael S. Elzerman, Senior Vice-President, as proprietor, has caused the land to be surveyed, divided, mapped and dedicated as represented on this plat and that Geddes Road is a public street and Windy Crest Drive is a private street only for the use of the lot owners and the owners of land west of and adjacent to Windy Crest Drive; that the public utility easements are private easements and that all other easements are for the uses shown on the plat.

Witnesses:

Robert L. Chappell Jr.  
Robert L. Chappell Jr.

Michigan National Bank - Ann Arbor  
302 S. Main Street  
Ann Arbor, Michigan  
Michael S. Elzerman  
Michael S. Elzerman  
Senior Vice-President

R.E. Fry  
R.E. FRY

ACKNOWLEDGEMENT

STATE OF MICHIGAN )  
County of Washtenaw ) ss.

Personally came before me this 4th day of September, 1980, Michael S. Elzerman, Senior Vice-President of the above named Corporation, to me known to be the person who executed the foregoing instrument and to me known to be such Senior Vice-President of said Corporation, and acknowledged that he executed the foregoing instrument as such officer as the free act and deed of said Corporation by its authority.

Barbara J. Pasoski  
Barbara J. Pasoski  
Notary Public Wayne  
Washtenaw County, Michigan  
My Commission expires: 6/1/82  
acting in Washtenaw County

PROPRIETOR'S CERTIFICATE - CORPORATION

Great Lakes Federal Savings and Loan Association, a corporation duly organized and existing under the laws of the United States, by Harry L. Vance, Senior Vice-President and Samuel B. VanBoven, Vice-President, as proprietor, has caused the land to be surveyed, divided, mapped and dedicated as represented on this plat and that Geddes Road is a public street and Windy Crest Drive is a private street only for the use of the lot owners and the owners of land west of and adjacent to Windy Crest Drive; that the public utility easements are private easements and that all other easements are for the uses shown on the plat.

Witnesses:

Great Lakes Federal Savings  
and Loan Association  
401 East Liberty Street  
Ann Arbor, Michigan 48104

Gregory C. Stout  
Gregory C. Stout

Harry L. Vance  
Harry L. Vance  
Senior Vice-President

Peter R. Sherman  
Peter R. Sherman

Samuel B. VanBoven  
Samuel B. VanBoven  
Vice-President

ACKNOWLEDGEMENT

STATE OF MICHIGAN )  
County of Washtenaw ) ss.

Personally came before me this 21st day of August, 1980, Harry L. Vance, Senior Vice-President and Samuel B. VanBoven, Vice-President of the above named Corporation, to me known to be the persons who executed the foregoing instrument and to me known to be such Senior Vice-President and Vice-President of said Corporation, and acknowledged that they executed the foregoing instrument as such officers as the free act and deed of said Corporation by its authority.

Peter R. Sherman  
Peter R. Sherman  
Notary Public, Washtenaw  
County, Michigan  
My Commission expires:  
March 8, 1983

PROPRIETOR'S CERTIFICATE

We as proprietor's certify that we have caused the land embraced in this plat to be surveyed, divided, mapped and dedicated as represented on this plat and that Geddes Road is a public street and Windy Crest Drive is a private street only for the use of the lot owners and the owners of land west of and adjacent to Windy Crest Drive; that the public utility easements are private easements and that all other easements are for the uses shown on the plat.

Witnesses:

David O. Peters  
David O. Peters

Chia-Tai Tsai  
Chia-Tai Tsai  
395 Windy Crest Drive  
Ann Arbor, MI 48105

Carol R. Peters  
Carol R. Peters

Chia Guat Lim-Tsai  
Chia Guat Lim-Tsai  
395 Windy Crest Drive  
Ann Arbor, MI 48105

ACKNOWLEDGEMENT

STATE OF MICHIGAN )  
County of Washtenaw ) ss.

Personally came before me this 20th day of August, 1980, the above named Chia-Tai Tsai and Chia Guat Lim-Tsai, husband and wife, to me known to be the persons who executed the foregoing instrument and acknowledged that they executed the same as their free act and deed.

Cheryl L. Fryberger  
Cheryl L. Fryberger  
Notary Public, Washtenaw  
County, Michigan  
My Commission expires: 6/19/84