

ADDENDUM No. 1

RFP No. 21-28

Treeline Urban Trail Land Analysis

Due: November 5, 2021 by 2:00 P.M. (local time)

The information contained herein shall take precedence over the original documents and all previous addenda (if any) and is appended thereto. **This Addendum includes 2 pages.**

The Proposer is to acknowledge receipt of this Addendum No. 1, including all attachments in its Proposal by so indicating in the proposal that the addendum has been received. Proposals submitted without acknowledgement of receipt of this addendum may be considered non-conforming.

The following forms provided within the RFP Document should be included in submitted proposal:

- **Attachment B – City of Ann Arbor Non-Discrimination Declaration of Compliance**
- **Attachment C - City of Ann Arbor Living Wage Declaration of Compliance**
- **Attachment D - Vendor Conflict of Interest Disclosure Form of the RFP Document**

Proposals that fail to provide these completed forms listed above upon proposal opening may be deemed non-responsive and may not be considered for award.

I. QUESTIONS AND ANSWERS

The following Questions have been received by the City. Responses are being provided in accordance with the terms of the RFP. Respondents are directed to take note in its review of the documents of the following questions and City responses as they affect work or details in other areas not specifically referenced here.

Question 1: What specific properties is the city interested in the consultant examining?

Answer 1: As stated in the RFP, the city is interested in the consultant examining “10 properties. However, the number of properties may be adjusted as needs are further determined.”

The 10 properties that are of key interest to the city are shown in the attached map. The parcel numbers are: 09-09-20-403-025, 09-09-20-403-013, 09-09-20-410-016, 09-09-20-403-025, 09-09-20-403-029, 09-09-20-411-014, 09-09-20-411-001, 09-09-20-409-006, 09-09-20-409-027, 09-09-20-409-008.

Offerors are responsible for any conclusions that they may draw from the information contained in the Addendum.

Treeline Route - Option 1 & Option 2

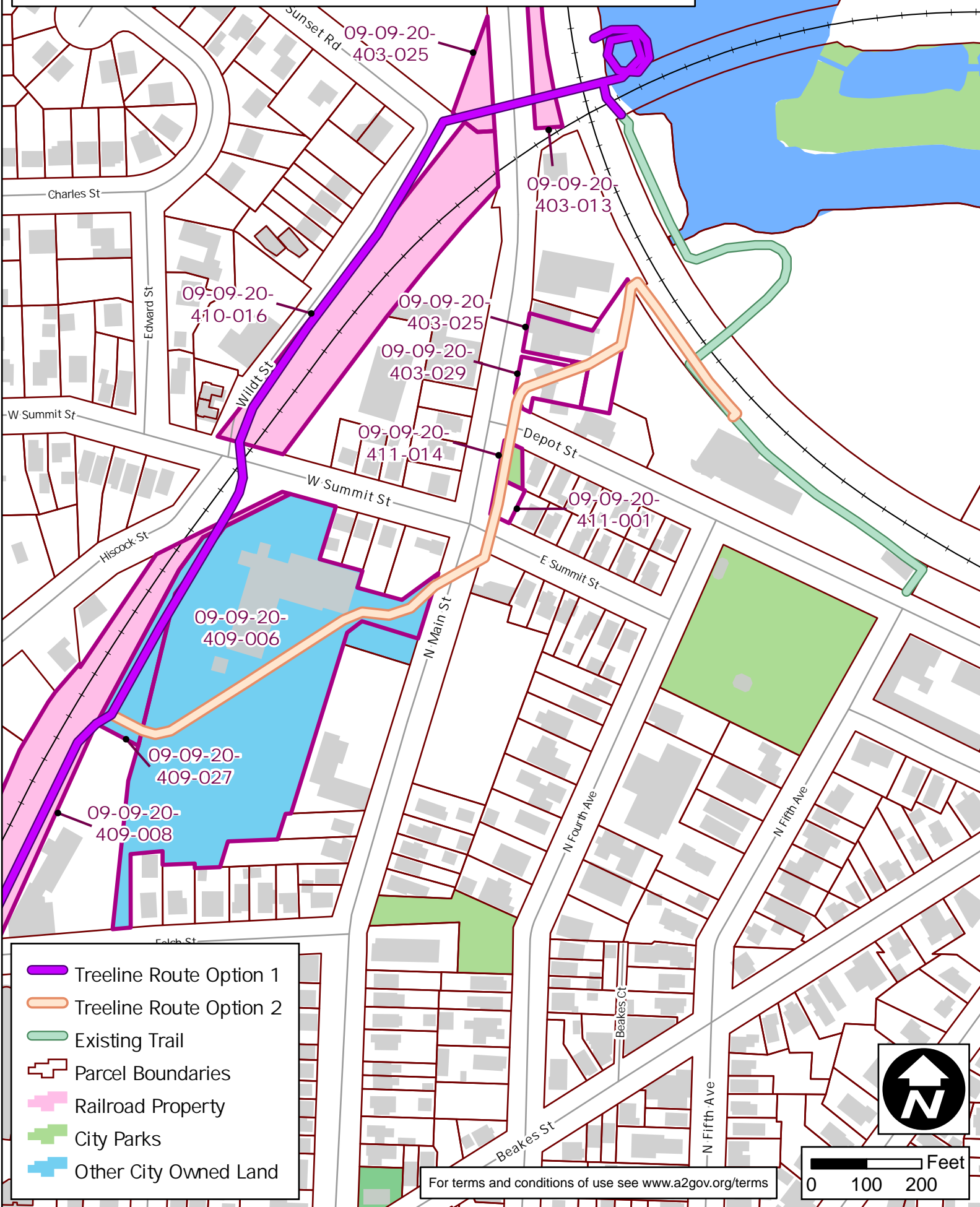

09-09-20-403-025

09-09-20-403-013

09-09-20-410-016

09-09-20-403-025

09-09-20-403-029

09-09-20-411-014

09-09-20-411-001

09-09-20-409-006

09-09-20-409-027

09-09-20-409-008

-  Treeline Route Option 1
-  Treeline Route Option 2
-  Existing Trail
-  Parcel Boundaries
-  Railroad Property
-  City Parks
-  Other City Owned Land

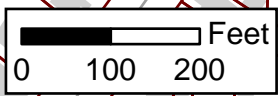

For terms and conditions of use see www.a2gov.org/terms