

Primary Control Point

AAGRS No. 0007A

City of Ann Arbor

NGS PID AA5181

Public Services Area • Project Management Unit

CONTROL STATION DATA SHEET

Approximate Location: M-14 and US-23

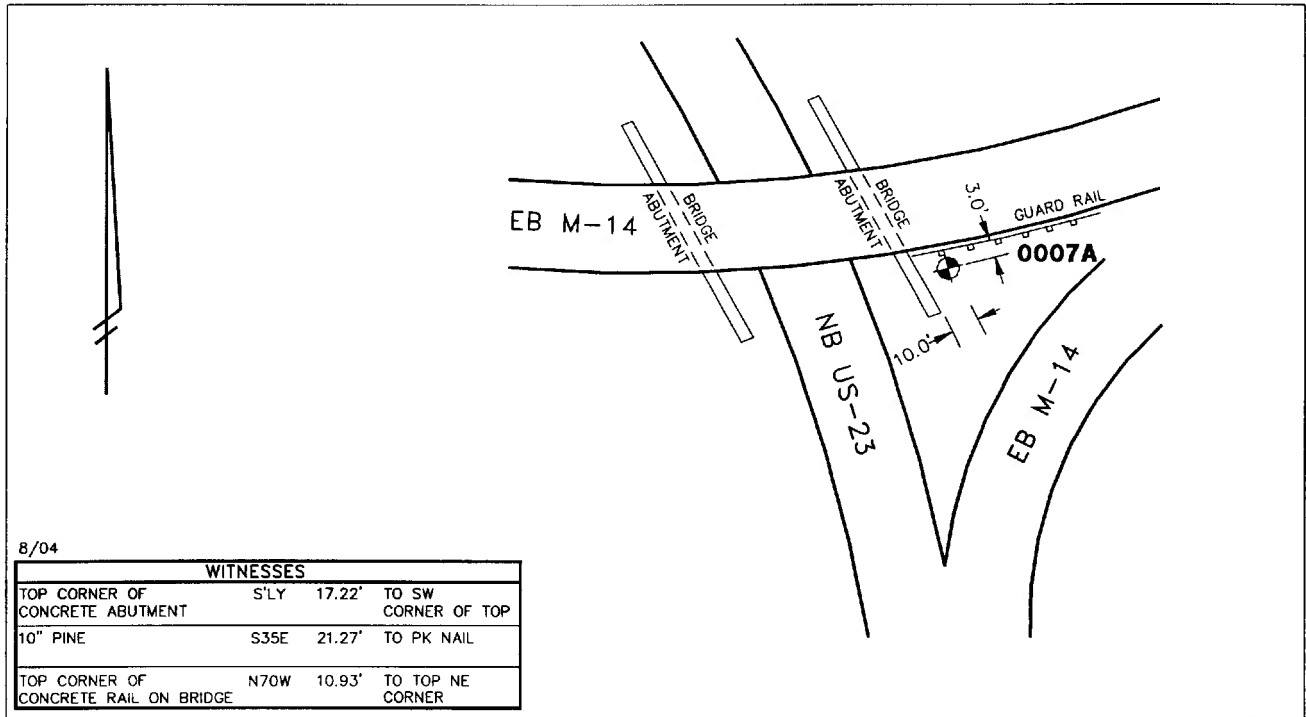

8/04

WITNESSES			
TOP CORNER OF CONCRETE ABUTMENT	S'LY	17.22'	TO SW CORNER OF TOP
10" PINE	S35E	21.27'	TO PK NAIL
TOP CORNER OF CONCRETE RAIL ON BRIDGE	N70W	10.93'	TO TOP NE CORNER

STATION 0007A IS LOCATED ON THE SOUTH SIDE OF EASTBOUND M-14, EASTERLY OF NORTHBOUND US-23 AND WESTERLY OF EASTBOUND M-14 FROM NORTHBOUND US-23, SAID STATION BEING IN THE SOUTHEAST 1/4 OF SECTION 11, ANN ARBOR TOWNSHIP, MICHIGAN. THE STATION IS LOCATED 10' EAST OF THE EASTERLY CONCRETE BRIDGE ABUTMENT TO THE HIGHEST EASTBOUND M-14 OVERPASS AND 3' SOUTH OF THE GUARDRAIL ON THE SOUTHERLY SIDE OF EASTBOUND M-14. SAID STATION IS PRIMARY CONTROL STATION AND IS DESCRIBED AS THE 1993 EDITION OF THE CITY OF ANN ARBOR BRASS DISC, SET IN CONCRETE PER DETAIL I AND IS FLUSH WITH THE GROUND. THIS STATION WAS SET BY THE CITY OF ANN ARBOR IN 1993 AND IS PAIRED WITH POINT 0007B.

Horizontal		Vertical	
Latitude (dms)	N 42 19 21.63848	Accuracy	2nd Order Class II
Longitude (dms)	W 83 41 22.58100	Datum	NAVD 88
State Plane Zone	2113 MI South	Elevation in meters	298.033
Scale	0.99995472	Elevation in International feet	977.80
Geoid Height in meters	-33.80		
Convergence (dms)	0 27 38.7		
Accuracy	1st Order		
Datum	NAD 83		No. 0007A
Easting (X) in meters	4055807.588		Sector: NE
Northing (Y) in meters	91605.797		
Easting (X) in International feet	13306455.341	Grid Azimuth to	
Northing (Y) in International feet	300543.953	Control Station 0007B	171°45'34"