

**City of Ann Arbor**  
**Public Services Area • Project Management Unit**  
**CONTROL STATION DATA SHEET**

Approximate Location: Glazier Way and Fuller Rd.

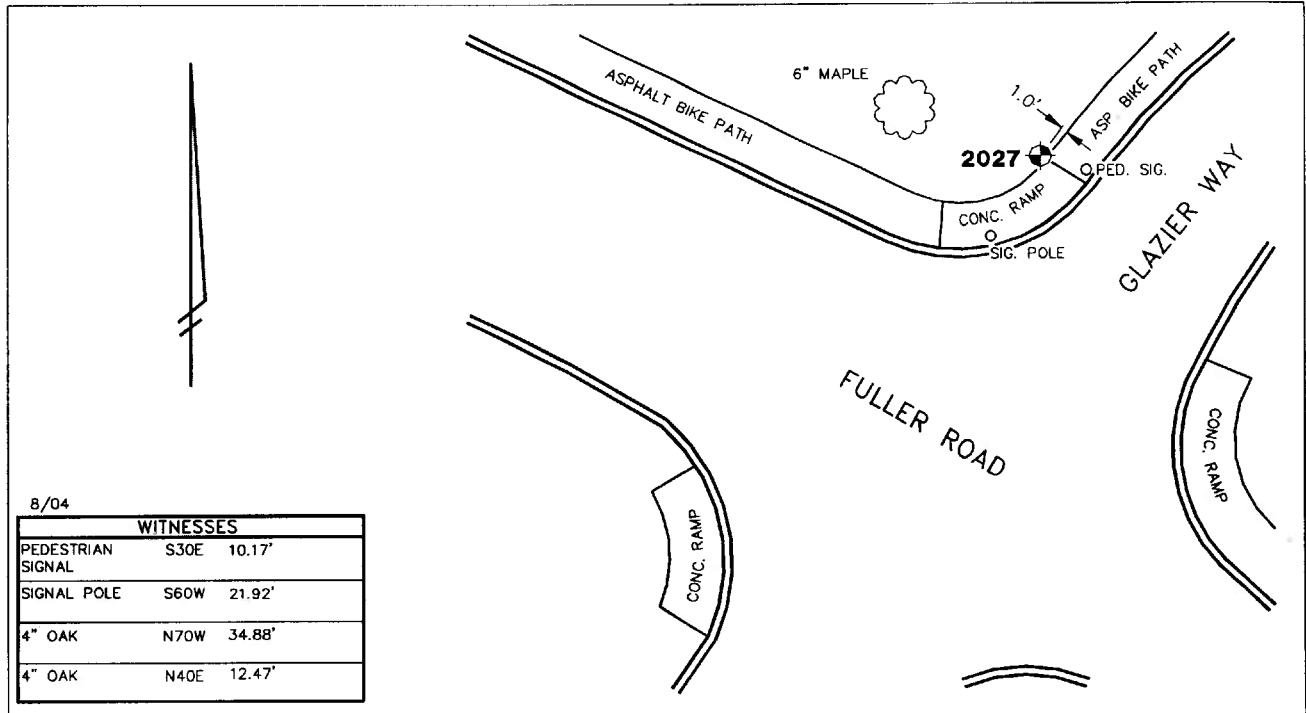

STATION 2027 IS LOCATED AT THE NORTHWEST CORNER OF GLAZIER WAY AND FULLER ROAD, SAID STATION BEING IN THE NORTHWEST 1/4 OF SECTION 27, ANN ARBOR TOWNSHIP IN THE CITY OF ANN ARBOR, MICHIGAN. THE STATION IS LOCATED 1.0' NORTHWESTERLY OF THE NORTHWESTERLY CORNER OF THE CONCRETE RAMP ALONG THE NORTHWESTERLY SIDE OF GLAZIER WAY AND 21.9' NORTHEASTERLY OF THE SIGNAL MAST ARM LOCATED AT THE NORTHWESTERLY CORNER OF GLAZIER WAY AND FULLER ROAD. SAID STATION IS A VERTICAL CONTROL STATION AND IS DESCRIBED AS THE 1993 EDITION OF THE CITY OF ANN ARBOR BRASS DISC, SET IN CONCRETE PER DETAIL II AND IS FLUSH WITH THE GROUND. THE STATION WAS SET BY THE CITY OF ANN ARBOR IN 2001.

**Benchmark**

**Vertical**

Accuracy	Local Control
Datum	NAVD 88
Elevation in meters	247.068
Elevation in International feet	810.59

**No. 2027**  
**Sector: EC**