

Primary Control Point

AAGRS No. 0010A

City of Ann Arbor

NGS PID NE1555

Public Services Area • Project Management Unit  
CONTROL STATION DATA SHEET

Approximate Location: Ellsworth Rd. at Platt Rd.

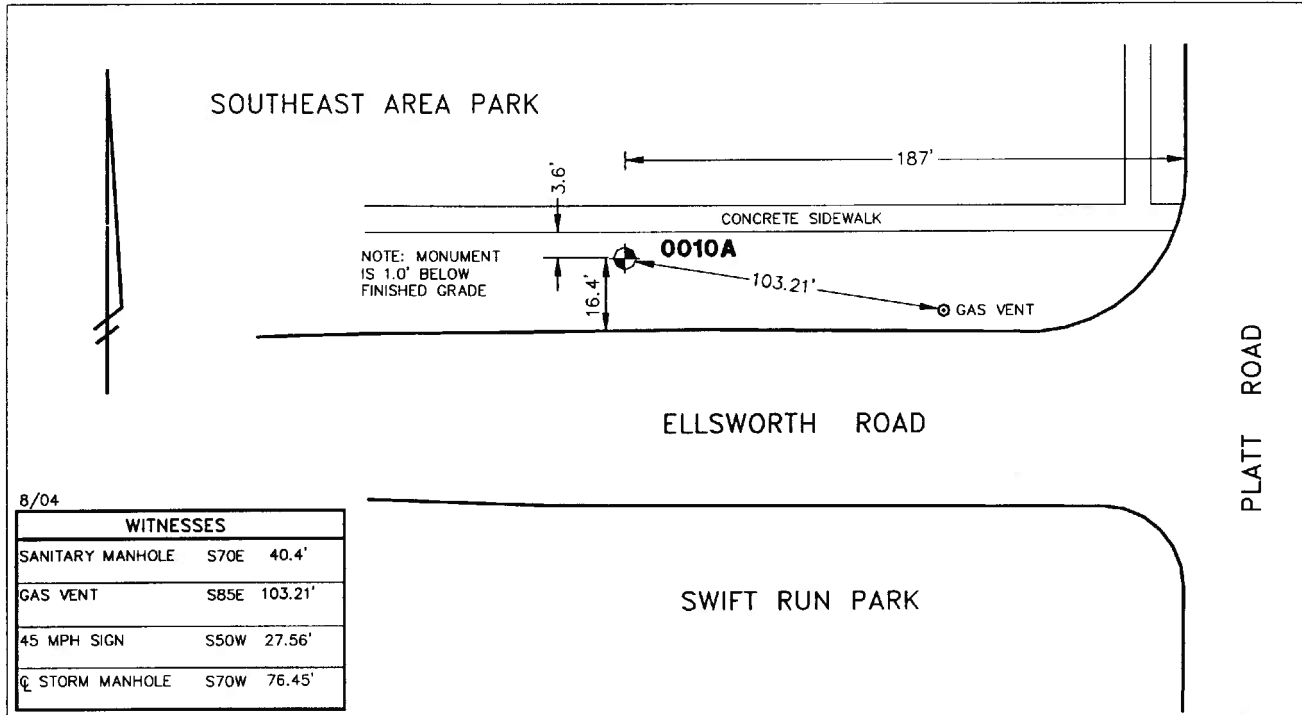

STATION 0010A IS LOCATED ON THE NORTH SIDE OF ELLSWORTH ROAD, APPROXIMATELY 187' WEST OF THE WEST BACK OF CURB ALONG PLATT ROAD, SAID STATION BEING IN THE SOUTHEAST 1/4 OF SECTION 10, PITTSFIELD TOWNSHIP IN THE CITY OF ANN ARBOR, MICHIGAN. THE STATION IS LOCATED 16.4' NORTH OF THE NORTH BACK OF CURB ALONG THE NORTH SIDE OF ELLSWORTH ROAD. SAID STATION IS A PRIMARY CONTROL STATION AND IS DESCRIBED AS AN MDOT DISC STAMPED: MICHIGAN DEPARTMENT OF TRANSPORTATION 81201 1989, AND IS SET IN CONCRETE 1.0' BELOW THE GROUND. THIS STATION IS AN MDOT STATION, WITH THE DESIGNATION: 81201, AND IS PAIRED WITH THE STATION 0010B.

Horizontal		Vertical	
Latitude (dms)	N 42 13 49.72345	Accuracy	2nd Order Class II
Longitude (dms)	W 83 42 1.90784	Datum	NAVD 88
State Plane Zone	2113 MI South	Elevation in meters	257.596
Scale	0.99997166	Elevation in International feet	845.13
Geoid Height in meters	-34.12		
Convergence (dms)	0 27 12.0		
Accuracy	1st Order		
Datum	NAD 83		No. 0010A
Easting (X) in meters	4054988.198		Sector: SE
Northing (Y) in meters	81358.015		
Easting (X) in International feet	13303767.054	Grid Azimuth to	
Northing (Y) in International feet	266922.621	Control Station 0010B	265°39'33"