

**City of Ann Arbor  
Public Services Area • Project Management Unit  
CONTROL STATION DATA SHEET**

**Approximate Location: W. Huron St. and Ashley St.**

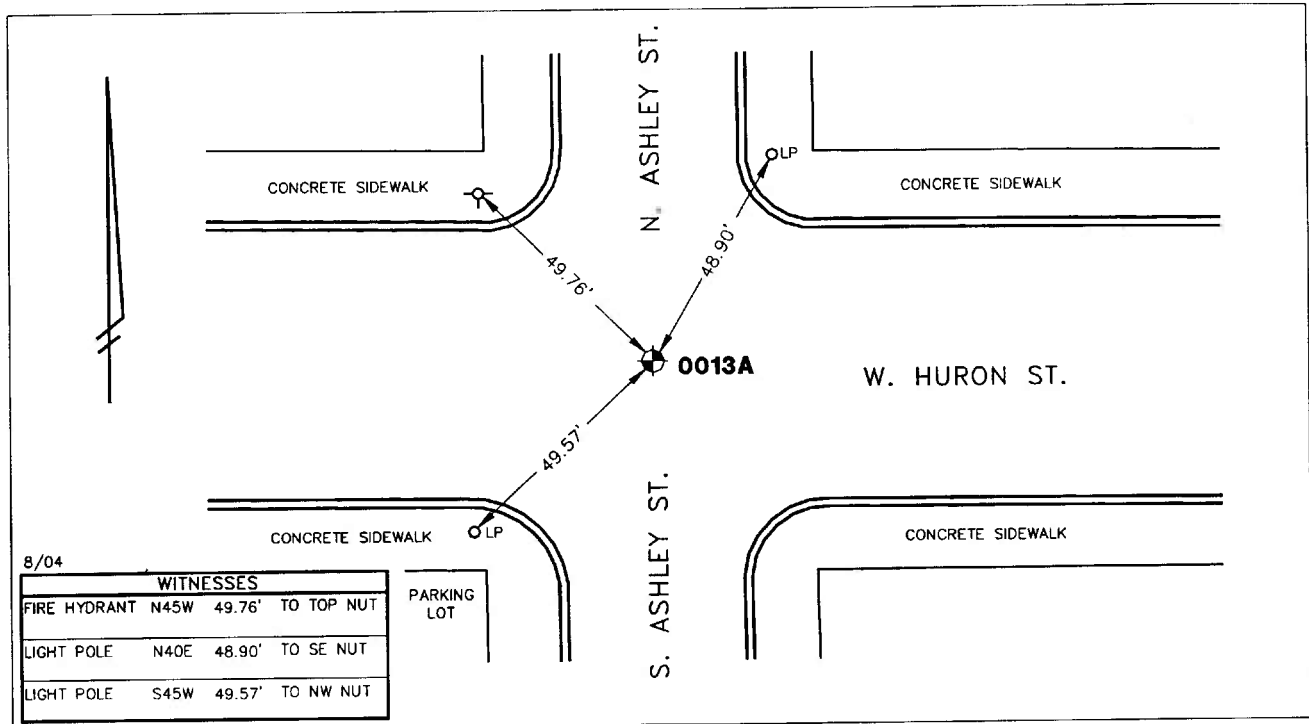

STATION 0013A IS LOCATED AT WEST HURON STREET AND ASHLEY STREET, SAID STATION BEING IN THE NORTHEAST 1/4 OF SECTION 29, ANN ARBOR TOWNSHIP IN THE CITY OF ANN ARBOR, MICHIGAN. THE STATION IS LOCATED AT THE CENTERLINE OF WEST HURON STREET AND ASHLEY STREET. SAID STATION IS PRIMARY CONTROL STATION AND IS DESCRIBED AS THE 1993 EDITION OF THE CITY OF ANN ARBOR BRASS DISC, SET IN CONCRETE PER DETAIL I AND IS ACCESSED BY A MONUMENT BOX SET FLUSH WITH THE ASPHALT. THIS STATION WAS SET BY THE CITY OF ANN ARBOR IN 1993 AND IS PAIRED WITH STATION 0013B.

Horizontal		Vertical	
Latitude (dms)	N 42 16 53.23435	Accuracy	2nd Order Class II
Longitude (dms)	W 83 44 59.10454	Datum	NAVD 88
State Plane Zone	2113 MI South	Elevation in meters	252.716
Scale	0.99996198	Elevation in International feet	829.12
Geoid Height in meters	-33.90		
Convergence (dms)	0 25 11.4		
Accuracy	1st Order		
Datum	NAD 83		<b>No. 0013A</b>
Easting (X) in meters	4050883.670		<b>Sector: WC</b>
Northing (Y) in meters	86988.957		
Easting (X) in International feet	13290300.755	<b>Grid Azimuth to</b>	
Northing (Y) in International feet	285396.841	<b>Control Station 0013B</b>	<b>272°07'06"</b>