

City of Ann Arbor
Public Services Area • Project Management Unit
CONTROL STATION DATA SHEET

Approximate Location: Plymouth Rd. and Nixon Rd.

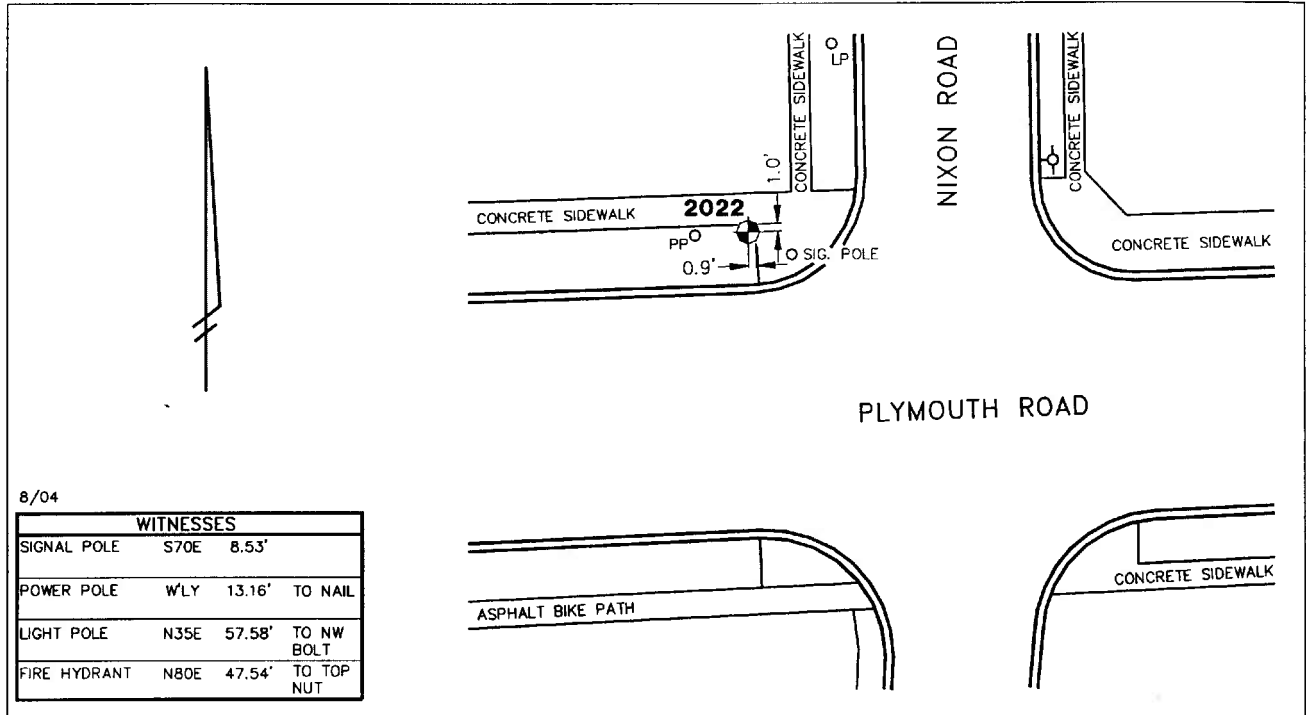

STATION 2022 IS LOCATED AT THE NORTHWEST CORNER OF PLYMOUTH ROAD AND NIXON ROAD, SAID STATION BEING IN THE SOUTHEAST 1/4 OF SECTION 15, ANN ARBOR TOWNSHIP IN THE CITY OF ANN ARBOR, MICHIGAN. THE STATION IS LOCATED 1.0' SOUTH OF THE SOUTH EDGE OF THE 8.0' CONCRETE WALK ALONG THE NORTH SIDE OF PLYMOUTH ROAD AND 0.9' WEST OF THE WEST EDGE OF THE CONCRETE WALK ALONG THE WEST SIDE OF NIXON ROAD. SAID STATION IS A VERTICAL CONTROL STATION AND IS DESCRIBED AS THE 1993 EDITION OF THE CITY OF ANN ARBOR BRASS DISC, SET IN CONCRETE PER DETAIL II AND IS FLUSH WITH THE GROUND. THE STATION WAS SET BY THE CITY OF ANN ARBOR IN 2001.

Benchmark

Vertical

Accuracy	Local Control
Datum	NAVD 88
Elevation in meters	275.088
Elevation in International feet	902.52

No. 2022
Sector: NE