

Bowers Addition to Ann Arbor.

Registers Office Washtenaw County p. Received & Recorded this 6th day of June A. D. 1844 at 3^{1/4} O'clock P.M. in Liber W. page 671.
Geo. W. Gilbert Register

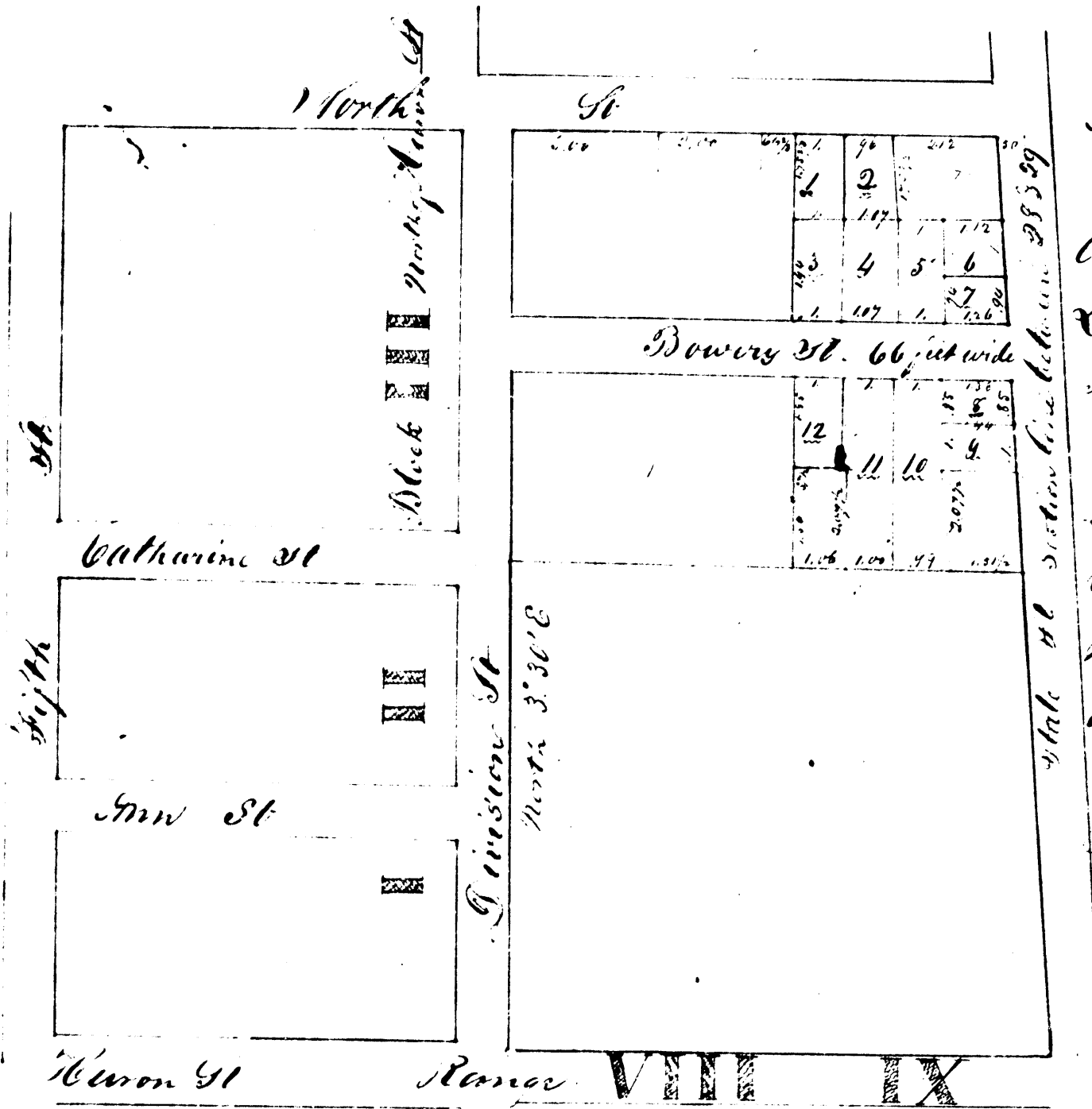

Plat of Bowers Addition to the Village of Ann Arbor. On the above Plat there is one Street 66 feet wide and 12 Lots Added to the Village of Ann Arbor.

Location. Block 3 North of Huron St Range 4 East.

The number of the Lots are marked thus 1, 2, 3, 4, 5, 6, 7, 8, 9, 10, 11, 12. the length and width of the Lots are marked in chains & links on the sides and ends of the lots. - Scale 4 ch or 16 rods to the inch. Variation 2° 30' Observed May 1844. by J. Pettibone
H. Bower

State of Michigan) I hereby certify that on this 6th day of June A.D. 1844, personally appeared before me Henry Bower (County of Washtenaw) and he acknowledged that he had caused the above survey to be made and the Plat to be drawn for the uses and purposes therein expressed.

Given under my hand at Ann Arbor the 6th day of June A.D. 1844 -
C. Clark, U.S. Judge Washtenaw Co.

And Ransom Dayton Register Office Washtenaw County p. Received & Recorded this 6th day of June A.D. 1844 at 4^{1/4} O'clock P.M. in Liber W. page 671 672 Geo. W. Gilbert Register
This Indenture, made the tenth day of April in the year of our Lord, one thousand eight hundred and forty three, between Ransom Dayton of Ann Arbor in the County of Washtenaw and State of Michigan of the first part and Horace Church of Ann Arbor in the County of Washtenaw and State of Michigan of the second part, Witnesseth, that the said party of the first part, for and in consideration of the sum of One Hundred Dollars to him in hand paid by the said party of the second part the receipt whereof is here by expressed and acknowledged, has granted, bargained, sold, aliened, released, confirmed and confirmed and by these presents do grant, bargain, sell, remise, release, alien and confirm unto the said party of the second part, and to his heirs and assigns forever, Situated in the Town of Ann Arbor in the County of Washtenaw and State of Michigan all that certain piece or parcel of Land known bounded and described as follows to wit: - Being a part of Lot number two in Block number nine in Brown & Fuller addition to the Village of Ann Arbor, commencing on the Easterly corner of said Lot number two on Wall Street, thence Northerly along the line of said Lot number two to the Northerly line of said Lot thence Westerly along the line of said Lot fifty feet, thence Southwesterly and parallel with the Easterly line of said Lot to Wall Street, thence Easterly along the line of Wall Street